

183rd St and Cicero Ave

<North and Southbound>

RLR Crash Data and Analysis

The table and chart below show a summary of motor vehicle crashes at the intersection of 183rd St and Cicero Ave over a span of 7 years. The data from 2007-2008 show the period prior to the installation of RLR cameras. The data from 2009 show the year in which the cameras were installed. The data from 2010-2013 show the period following the installation.

| | Turning | Rear End | Angle | Fixed Object | Other | Total |
|-------------|---------|----------|-------|--------------|-------|-----------|
| 2007 | 8 | 2 | 2 | 2 | 2 | 16 |
| 2008 | 6 | 3 | 2 | 0 | 1 | 12 |
| 2009 | 4 | 6 | 0 | 0 | 0 | 10 |
| 2010 | 1 | 4 | 2 | 0 | 0 | 7 |
| 2011 | 3 | 2 | 2 | 0 | 0 | 7 |
| 2012 | 1 | 2 | 0 | 0 | 0 | 3 |
| 2013 | 4 | 3 | 1 | 0 | 0 | 8 |

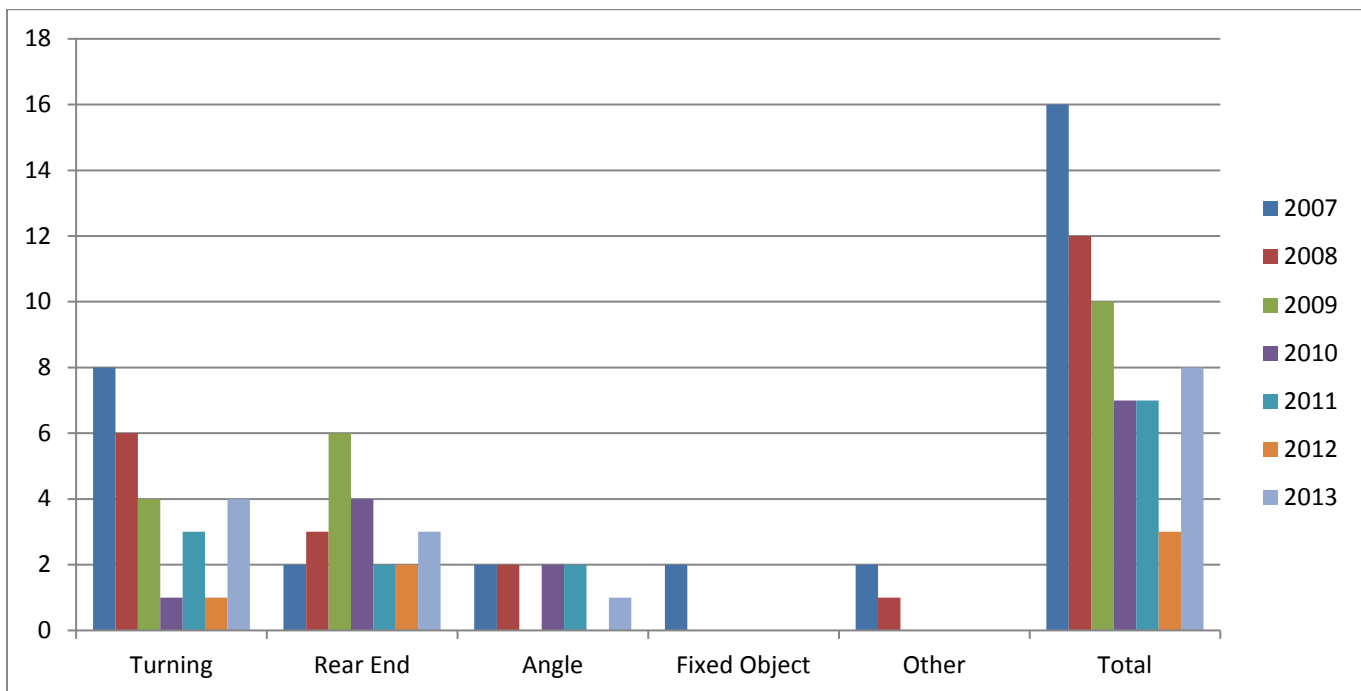

In 2008 the Average Daily Traffic (ADT) volume along 183rd St reached 9,100 to 16,500 cars at the intersection of 183rd St and Cicero Ave. The ADT along Cicero Ave reached 16,600 to 18,800 according to IDOT.

By 2010 the ADT along 183rd St had not changed. The ADT along Cicero Ave had decreased somewhat (14,600 to 16,800) at this location. The rate of crashes in 2010 was reduced by 44.8% in comparison to the previous 3-year average.

By 2013 there was a slight decrease in ADT along Cicero Ave (14,500 to 14,600), an increase along 183rd St to the east of Cicero Ave (18,600) and a slight decrease to the west of Cicero Ave (8,200). The average rate of crashes per year following the installation of RLR cameras was 51.7% lower than the per year average from 2007-2009.

Insert Crash Data here. 2013, 2012, 2012, 2011, 2010, 2009, 2008, 2007.
Full page reports from IDOT. (Delete this page in PDF)

Collision Diagram

1/1/2013 to 12/31/2013

Crash Route: IL050 | From MileStation 33.41 to 33.41 | County : Cook | Intersection Related: Intersections | *See Notes at End of Report.

| Date | Weather | Roadway | ----- A | Injuries B | ----- C | Killed | Type of Crash | Light Condition | Mile | Vehicle Type | DIRP | Maneuver | Event 1 | Loc 1 | Event 2 | Loc 2 | Event 3 | Loc 3 | Unit |
|---------------------|---------|---------------|------------|---------------|------------|--------|---------------|------------------------|-------|--------------|-----------|----------------|--------------------------|-----------------------|--------------------------|-----------------------|---------|-------|------|
| 201301025541 | | | | | | | | | | | | | | | | | | | |
| 1/5/2013 8:55 PM | Snow | Snow or Slush | 0 | 0 | 0 | 0 | Rear End | Darkness/ Lighted Road | 33.41 | Passenger | West | Straight Ahead | Motor Vehicle In Traffic | Intersection | (UNK) | (UNK) | (UNK) | (UNK) | 1 |
| | | | | | | | | | | Passenger | West | Straight Ahead | Motor Vehicle In Traffic | Intersection | (UNK) | (UNK) | (UNK) | (UNK) | 2 |
| 201301059412 | | | | | | | | | | | | | | | | | | | |
| 2/5/2013 7:20 AM | Snow | Snow or Slush | 1 | 1 | 0 | 0 | Turning | Daylight | 33.41 | SUV | Southeast | Turning Left | Motor Vehicle In Traffic | On Pavement (Roadway) | (UNK) | (UNK) | (UNK) | (UNK) | 1 |
| | | | | | | | | | | Passenger | North | Straight Ahead | Motor Vehicle In Traffic | On Pavement (Roadway) | (UNK) | (UNK) | (UNK) | (UNK) | 2 |
| 201301119349 | | | | | | | | | | | | | | | | | | | |
| 4/17/2013 10:15 AM | Clear | Dry | 0 | 2 | 0 | 0 | Turning | Daylight | 33.41 | Passenger | East | Straight Ahead | Motor Vehicle In Traffic | On Pavement (Roadway) | (UNK) | (UNK) | (UNK) | (UNK) | 1 |
| | | | | | | | | | | Passenger | South | Turning Left | Motor Vehicle In Traffic | On Pavement (Roadway) | (UNK) | (UNK) | (UNK) | (UNK) | 2 |
| 201301074252 | | | | | | | | | | | | | | | | | | | |
| 5/24/2013 11:05 AM | Clear | Dry | 2 | 0 | 0 | 0 | Angle | Daylight | 33.41 | Passenger | North | Straight Ahead | Motor Vehicle In Traffic | Intersection | (UNK) | (UNK) | (UNK) | (UNK) | 1 |
| | | | | | | | | | | Van/Mini-Van | East | Straight Ahead | Motor Vehicle In Traffic | Intersection | (UNK) | (UNK) | (UNK) | (UNK) | 2 |
| 201301139873 | | | | | | | | | | | | | | | | | | | |
| 6/9/2013 12:30 PM | Clear | Dry | 0 | 0 | 0 | 0 | Rear End | Daylight | 33.41 | SUV | North | Straight Ahead | Motor Vehicle In Traffic | On Pavement (Roadway) | (UNK) | (UNK) | (UNK) | (UNK) | 1 |
| | | | | | | | | | | Van/Mini-Van | North | Straight Ahead | Motor Vehicle In Traffic | On Pavement (Roadway) | Motor Vehicle In Traffic | On Pavement (Roadway) | (UNK) | (UNK) | 2 |
| | | | | | | | | | | Van/Mini-Van | North | Straight Ahead | Motor Vehicle In Traffic | On Pavement (Roadway) | (UNK) | (UNK) | (UNK) | (UNK) | 3 |

Collision Diagram

1/1/2013 to 12/31/2013

Crash Route: IL050 | From MileStation 33.41 to 33.41 | County : Cook | Intersection Related: Intersections | *See Notes at End of Report.

| Date | Weather | Roadway | ----- A | Injuries B | ----- C | Killed | Type of Crash | Light Condition | Mile | Vehicle Type | DIRP | Maneuver | Event 1 | Loc 1 | Event 2 | Loc 2 | Event 3 | Loc 3 | Unit |
|---------------------|---------|---------|------------|---------------|------------|--------|---------------|------------------------|-------|--------------|-----------|----------------------|--------------------------|-----------------------|---------|-------|---------|-------|------|
| 201301350971 | | | | | | | | | | | | | | | | | | | |
| 10/2/2013 2:29 PM | Clear | Dry | 0 | 1 | 2 | 0 | Turning | Daylight | 33.41 | Passenger | Northwest | Turning Left | Motor Vehicle In Traffic | On Pavement (Roadway) | (UNK) | (UNK) | (UNK) | (UNK) | 1 |
| | | | | | | | | | | Pickup | South | Turning Left | Motor Vehicle In Traffic | On Pavement (Roadway) | (UNK) | (UNK) | (UNK) | (UNK) | 2 |
| 201301223801 | | | | | | | | | | | | | | | | | | | |
| 10/18/2013 10:03 PM | Clear | Dry | 0 | 1 | 0 | 1 | Turning | Darkness/ Lighted Road | 33.41 | Passenger | South | Turning Left | Motor Vehicle In Traffic | Intersection | (UNK) | (UNK) | (UNK) | (UNK) | 1 |
| | | | | | | | | | | Passenger | North | Straight Ahead | Motor Vehicle In Traffic | Intersection | (UNK) | (UNK) | (UNK) | (UNK) | 2 |
| 201301404685 | | | | | | | | | | | | | | | | | | | |
| 11/29/2013 11:00 AM | Clear | Dry | 0 | 1 | 1 | 0 | Rear End | Daylight | 33.41 | Passenger | North | Straight Ahead | Motor Vehicle In Traffic | On Pavement (Roadway) | (UNK) | (UNK) | (UNK) | (UNK) | 1 |
| | | | | | | | | | | Passenger | North | Slow/Stop In Traffic | Motor Vehicle In Traffic | On Pavement (Roadway) | (UNK) | (UNK) | (UNK) | (UNK) | 2 |

Collision Diagram

1/1/2013 to 12/31/2013

Crash Route: IL050 | From MileStation 33.41 to 33.41 | County : Cook | Intersection Related: Intersections | *See Notes at End of Report.

| TOTAL CRASHES | FATAL CRASHES | A INJURY CRASHES | B INJURY CRASHES | C INJURY CRASHES | PROPERTY DAMAGE CRASHES | TOTAL KILLED | TOTAL INJURED | A INJURIES | B INJURIES | C INJURIES |
|---------------|---------------|------------------|------------------|------------------|-------------------------|--------------|---------------|------------|------------|------------|
| 8 | 1 | 2 | 3 | 0 | 2 | 1 | 12 | 3 | 6 | 3 |

| Type of Crash | Total | % | Day of Wk | Total | % | Hour of Day | Total | % | Vehicle Type | Total | % |
|---------------|----------|-------|------------------------|----------|-------|---------------|----------|-------|---------------|-----------|-------|
| Angle | 1 | 12.5% | Tuesday | 1 | 12.5% | 07 AM | 1 | 12.5% | Passenger | 11 | 64.7% |
| Rear End | 3 | 37.5% | Wednesday | 2 | 25.0% | 10 AM | 1 | 12.5% | Pickup | 1 | 5.9% |
| Turning | 4 | 50.0% | Friday | 3 | 37.5% | 11 AM | 2 | 25.0% | SUV | 2 | 11.8% |
| TOTAL: | 8 | | Saturday | 1 | 12.5% | Noon | 1 | 12.5% | Van/Mini-Van | 3 | 17.6% |
| | | | Sunday | 1 | 12.5% | 2 PM | 1 | 12.5% | TOTAL: | 17 | |
| | | | TOTAL: | 8 | | 8 PM | 1 | 12.5% | | | |
| | | | | | | 10 PM | 1 | 12.5% | | | |
| | | | | | | TOTAL: | 8 | | | | |
| Weather Cond | Total | % | Light Cond | Total | % | Road Surface | Total | % | DIRP | Total | % |
| Clear | 6 | 75.0% | Darkness/ Lighted Road | 2 | 25.0% | Dry | 6 | 75.0% | East | 2 | 11.8% |
| Snow | 2 | 25.0% | Daylight | 6 | 75.0% | Snow or Slush | 2 | 25.0% | North | 8 | 47.1% |
| TOTAL: | 8 | | TOTAL: | 8 | | TOTAL: | 8 | | Northwest | 1 | 5.9% |
| | | | | | | | | | South | 3 | 17.6% |
| | | | | | | | | | Southeast | 1 | 5.9% |
| | | | | | | | | | West | 2 | 11.8% |
| | | | | | | | | | TOTAL: | 17 | |

Collision Diagram

1/1/2013 to 12/31/2013

Crash Route: IL050 | From MileStation 33.41 to 33.41 | County : Cook | Intersection Related: Intersections | *See Notes at End of Report.

Notes

Current year and previous year data are not yet complete and are subject to change as more information becomes available. Calendar date selections include data based on the date of the crash. Year selections include data based on the statistical year in which the crash was processed.

The intersection-related field could be incorrect and affect the data on the report.

If a crash occurs between two municipalities, it may be coded to another city/county from what is on the crash report.

Crashes with incomplete location information are not included.

Areas where routes have more than one junction have been known to cause problems in determining accurate locations. Please notify us to verify the data for intersections with more than one junction.

For roadway segments which include the intersection of two routes, the intersection report may need to be run on the other route in order to get all the crashes.

Collision Diagram

1/1/2012 to 12/31/2012

Crash Route: IL050 | From MileStation 33.41 to 33.41 | County : Cook | Intersection Related: Intersections | *See Notes at End of Report.

| Date | Weather | Roadway | ----- A | Injuries B | ----- C | Killed | Type of Crash | Light Condition | Mile | Vehicle Type | DIRP | Maneuver | Event 1 | Loc 1 | Event 2 | Loc 2 | Event 3 | Loc 3 | Unit |
|---------------------|---------|---------|------------|---------------|------------|--------|---------------|------------------------|-------|--------------|-------|-----------------------|--------------------------|-----------------------|---------|-------|---------|-------|------|
| 201201077071 | | | | | | | | | | | | | | | | | | | |
| 2/8/2012 6:53 AM | Snow | Ice | 0 | 0 | 0 | 0 | Rear End | Dawn | 33.41 | SUV | West | Skidding/Control Loss | Motor Vehicle In Traffic | On Pavement (Roadway) | (UNK) | (UNK) | (UNK) | (UNK) | 1 |
| | | | | | | | | | | SUV | West | Slow/Stop In Traffic | Motor Vehicle In Traffic | On Pavement (Roadway) | (UNK) | (UNK) | (UNK) | (UNK) | 2 |
| 201201112078 | | | | | | | | | | | | | | | | | | | |
| 4/5/2012 8:45 PM | Clear | Dry | 0 | 0 | 0 | 0 | Turning | Darkness, Lighted Road | 33.41 | Passenger | North | Turning Left | Motor Vehicle In Traffic | On Pavement (Roadway) | (UNK) | (UNK) | (UNK) | (UNK) | 1 |
| | | | | | | | | | | Passenger | South | Straight Ahead | Motor Vehicle In Traffic | On Pavement (Roadway) | (UNK) | (UNK) | (UNK) | (UNK) | 2 |
| 201201237009 | | | | | | | | | | | | | | | | | | | |
| 6/19/2012 11:10 AM | Clear | Unknown | 0 | 0 | 0 | 0 | Rear End | Daylight | 33.41 | Van/Mini-Van | South | Straight Ahead | Motor Vehicle In Traffic | On Pavement (Roadway) | (UNK) | (UNK) | (UNK) | (UNK) | 1 |
| | | | | | | | | | | SUV | South | Slow/Stop In Traffic | Motor Vehicle In Traffic | On Pavement (Roadway) | (UNK) | (UNK) | (UNK) | (UNK) | 2 |

Collision Diagram

1/1/2012 to 12/31/2012

Crash Route: IL050 | From MileStation 33.41 to 33.41 | County : Cook | Intersection Related: Intersections | *See Notes at End of Report.

| TOTAL CRASHES | FATAL CRASHES | A INJURY CRASHES | B INJURY CRASHES | C INJURY CRASHES | PROPERTY DAMAGE CRASHES | TOTAL KILLED | TOTAL INJURED | A INJURIES | B INJURIES | C INJURIES |
|---------------|---------------|------------------|------------------|------------------|-------------------------|--------------|---------------|------------|------------|------------|
| 3 | 0 | 0 | 0 | 0 | 3 | 0 | 0 | 0 | 0 | 0 |

| Type of Crash | Total | % | Day of Wk | Total | % | Hour of Day | Total | % | Vehicle Type | Total | % |
|---------------|----------|-------|---------------|----------|-------|---------------|----------|-------|---------------|----------|-------|
| Rear End | 2 | 66.7% | Tuesday | 1 | 33.3% | 06 AM | 1 | 33.3% | Passenger | 2 | 33.3% |
| Turning | 1 | 33.3% | Wednesday | 1 | 33.3% | 11 AM | 1 | 33.3% | SUV | 3 | 50.0% |
| TOTAL: | 3 | | Thursday | 1 | 33.3% | 8 PM | 1 | 33.3% | Van/Mini-Van | 1 | 16.7% |
| | | | TOTAL: | 3 | | TOTAL: | 3 | | TOTAL: | 6 | |

| Weather Cond | Total | % | Light Cond | Total | % | Road Surface | Total | % | DIRP | Total | % |
|---------------|----------|-------|------------------------|----------|-------|---------------|----------|-------|---------------|----------|-------|
| Clear | 2 | 66.7% | Darkness, Lighted Road | 1 | 33.3% | Dry | 1 | 33.3% | North | 1 | 16.7% |
| Snow | 1 | 33.3% | Dawn | 1 | 33.3% | Ice | 1 | 33.3% | South | 3 | 50.0% |
| TOTAL: | 3 | | Daylight | 1 | 33.3% | Unknown | 1 | 33.3% | West | 2 | 33.3% |
| | | | TOTAL: | 3 | | TOTAL: | 3 | | TOTAL: | 6 | |

Collision Diagram

1/1/2012 to 12/31/2012

Crash Route: IL050 | From MileStation 33.41 to 33.41 | County : Cook | Intersection Related: Intersections | *See Notes at End of Report.

Notes

Current year and previous year data are not yet complete and are subject to change as more information becomes available. Calendar date selections include data based on the date of the crash. Year selections include data based on the statistical year in which the crash was processed.

The intersection-related field could be incorrect and affect the data on the report.

If a crash occurs between two municipalities, it may be coded to another city/county from what is on the crash report.

Crashes with incomplete location information are not included.

Areas where routes have more than one junction have been known to cause problems in determining accurate locations. Please notify us to verify the data for intersections with more than one junction.

For roadway segments which include the intersection of two routes, the intersection report may need to be run on the other route in order to get all the crashes.

Collision Diagram

1/1/2011 to 12/31/2011

Crash Route: IL050 | From MileStation 33.41 to 33.41 | County : Cook | Intersection Related: Intersections | *See Notes at End of Report.

| Date | Weather | Roadway | ----- A | Injuries B | ----- C | Killed | Type of Crash | Light Condition | Mile | Vehicle Type | DIRP | Maneuver | Event 1 | Loc 1 | Event 2 | Loc 2 | Event 3 | Loc 3 | Unit |
|---------------------|---------|---------|------------|---------------|------------|--------|---------------|------------------------|-------|--------------|-----------|-----------------------|--------------------------|-----------------------|--------------------------|-----------------------|---------|-------|------|
| 201101089960 | | | | | | | | | | | | | | | | | | | |
| 2/21/2011 11:45 PM | Clear | Ice | 0 | 0 | 0 | 0 | Turning | Darkness, Lighted Road | 33.41 | Passenger | South | Turning Left | Motor Vehicle In Traffic | On Pavement (Roadway) | (UNK) | (UNK) | (UNK) | (UNK) | 1 |
| | | | | | | | | | | SUV | North | Straight Ahead | Motor Vehicle In Traffic | On Pavement (Roadway) | (UNK) | (UNK) | (UNK) | (UNK) | 2 |
| 201101276730 | | | | | | | | | | | | | | | | | | | |
| 8/6/2011 3:09 AM | Rain | Unknown | 0 | 0 | 0 | 0 | Rear End | Darkness, Lighted Road | 33.41 | Van/Mini-Van | North | Skidding/Control Loss | Motor Vehicle In Traffic | Intersection | (UNK) | (UNK) | (UNK) | (UNK) | 1 |
| | | | | | | | | | | Passenger | North | Slow/Stop In Traffic | Motor Vehicle In Traffic | Intersection | (UNK) | (UNK) | (UNK) | (UNK) | 2 |
| 201101276728 | | | | | | | | | | | | | | | | | | | |
| 8/6/2011 8:21 PM | Clear | Dry | 0 | 0 | 0 | 0 | Turning | Dusk | 33.41 | Passenger | Northwest | Turning Left | Motor Vehicle In Traffic | Intersection | (UNK) | (UNK) | (UNK) | (UNK) | 1 |
| | | | | | | | | | | Passenger | West | Straight Ahead | Motor Vehicle In Traffic | Intersection | (UNK) | (UNK) | (UNK) | (UNK) | 2 |
| 201101283078 | | | | | | | | | | | | | | | | | | | |
| 8/13/2011 5:55 PM | Rain | Wet | 0 | 2 | 0 | 0 | Angle | Daylight | 33.41 | Passenger | East | Straight Ahead | Motor Vehicle In Traffic | Intersection | (UNK) | (UNK) | (UNK) | (UNK) | 1 |
| | | | | | | | | | | Passenger | North | Straight Ahead | Motor Vehicle In Traffic | Intersection | (UNK) | (UNK) | (UNK) | (UNK) | 2 |
| 201101366050 | | | | | | | | | | | | | | | | | | | |
| 10/15/2011 1:25 PM | Clear | Dry | 0 | 0 | 1 | 0 | Turning | Daylight | 33.41 | SUV | Southeast | Turning Left | Motor Vehicle In Traffic | On Pavement (Roadway) | Motor Vehicle In Traffic | On Pavement (Roadway) | (UNK) | (UNK) | 1 |
| | | | | | | | | | | Passenger | Southeast | Straight Ahead | Motor Vehicle In Traffic | On Pavement (Roadway) | (UNK) | (UNK) | (UNK) | (UNK) | 2 |
| | | | | | | | | | | Passenger | West | Slow/Stop In Traffic | Motor Vehicle In Traffic | On Pavement (Roadway) | (UNK) | (UNK) | (UNK) | (UNK) | 3 |

Collision Diagram

1/1/2011 to 12/31/2011

Crash Route: IL050 | From MileStation 33.41 to 33.41 | County : Cook | Intersection Related: Intersections | *See Notes at End of Report.

| Date | Weather | Roadway | ----- A | Injuries B | ----- C | Killed | Type of Crash | Light Condition | Mile | Vehicle Type | DIRP | Maneuver | Event 1 | Loc 1 | Event 2 | Loc 2 | Event 3 | Loc 3 | Unit |
|---------------------|---------|---------|------------|---------------|------------|--------|---------------|------------------------|-------|--------------|-------|----------------------|--------------------------|-----------------------|--------------------------|-----------------------|---------|-------|------|
| 201101379492 | | | | | | | | | | | | | | | | | | | |
| 10/26/2011 10:42 PM | Clear | Dry | 0 | 2 | 0 | 1 | Angle | Darkness, Lighted Road | 33.41 | SUV | East | Straight Ahead | Motor Vehicle In Traffic | Intersection | Motor Vehicle In Traffic | Intersection | (UNK) | (UNK) | 1 |
| | | | | | | | | | | SUV | North | Straight Ahead | Motor Vehicle In Traffic | Intersection | Overturn | On Pavement (Roadway) | (UNK) | (UNK) | 2 |
| | | | | | | | | | | SUV | West | Slow/Stop In Traffic | Motor Vehicle In Traffic | Intersection | (UNK) | (UNK) | (UNK) | (UNK) | 3 |
| 201101406937 | | | | | | | | | | | | | | | | | | | |
| 11/10/2011 9:27 AM | Clear | Dry | 0 | 0 | 2 | 0 | Rear End | Daylight | 33.41 | Van/Mini-Van | East | Slow/Stop In Traffic | Motor Vehicle In Traffic | On Pavement (Roadway) | (UNK) | (UNK) | (UNK) | (UNK) | 2 |
| | | | | | | | | | | Passenger | East | Straight Ahead | Motor Vehicle In Traffic | On Pavement (Roadway) | (UNK) | (UNK) | (UNK) | (UNK) | 1 |

Collision Diagram

1/1/2011 to 12/31/2011

Crash Route: IL050 | From MileStation 33.41 to 33.41 | County : Cook | Intersection Related: Intersections | *See Notes at End of Report.

| TOTAL CRASHES | FATAL CRASHES | A INJURY CRASHES | B INJURY CRASHES | C INJURY CRASHES | PROPERTY DAMAGE CRASHES | TOTAL KILLED | TOTAL INJURED | A INJURIES | B INJURIES | C INJURIES |
|---------------|---------------|------------------|------------------|------------------|-------------------------|--------------|---------------|------------|------------|------------|
| 7 | 1 | 0 | 1 | 2 | 3 | 1 | 7 | 0 | 4 | 3 |

| Type of Crash | Total | % | Day of Wk | Total | % | Hour of Day | Total | % | Vehicle Type | Total | % |
|---------------|----------|-------|------------------------|----------|-------|---------------|----------|-------|---------------|-----------|-------|
| Angle | 2 | 28.6% | Monday | 1 | 14.3% | 03 AM | 1 | 14.3% | Passenger | 9 | 56.3% |
| Rear End | 2 | 28.6% | Wednesday | 1 | 14.3% | 09 AM | 1 | 14.3% | SUV | 5 | 31.3% |
| Turning | 3 | 42.9% | Thursday | 1 | 14.3% | 1 PM | 1 | 14.3% | Van/Mini-Van | 2 | 12.5% |
| TOTAL: | 7 | | Saturday | 4 | 57.1% | 5 PM | 1 | 14.3% | TOTAL: | 16 | |
| | | | TOTAL: | 7 | | 8 PM | 1 | 14.3% | | | |
| | | | | | | 10 PM | 1 | 14.3% | | | |
| | | | | | | 11 PM | 1 | 14.3% | | | |
| | | | | | | TOTAL: | 7 | | | | |
| Weather Cond | Total | % | Light Cond | Total | % | Road Surface | Total | % | DIRP | Total | % |
| Clear | 5 | 71.4% | Darkness, Lighted Road | 3 | 42.9% | Dry | 4 | 57.1% | East | 4 | 25.0% |
| Rain | 2 | 28.6% | Daylight | 3 | 42.9% | Ice | 1 | 14.3% | North | 5 | 31.3% |
| TOTAL: | 7 | | Dusk | 1 | 14.3% | Unknown | 1 | 14.3% | Northwest | 1 | 6.3% |
| | | | TOTAL: | 7 | | Wet | 1 | 14.3% | South | 1 | 6.3% |
| | | | | | | TOTAL: | 7 | | Southeast | 2 | 12.5% |
| | | | | | | | | | West | 3 | 18.8% |
| | | | | | | | | | TOTAL: | 16 | |

Collision Diagram

1/1/2011 to 12/31/2011

Crash Route: IL050 | From MileStation 33.41 to 33.41 | County : Cook | Intersection Related: Intersections | *See Notes at End of Report.

Notes

Current year and previous year data are not yet complete and are subject to change as more information becomes available. Calendar date selections include data based on the date of the crash. Year selections include data based on the statistical year in which the crash was processed.

The intersection-related field could be incorrect and affect the data on the report.

If a crash occurs between two municipalities, it may be coded to another city/county from what is on the crash report.

Crashes with incomplete location information are not included.

Areas where routes have more than one junction have been known to cause problems in determining accurate locations. Please notify us to verify the data for intersections with more than one junction.

For roadway segments which include the intersection of two routes, the intersection report may need to be run on the other route in order to get all the crashes.

Collision Diagram

1/1/2010 to 12/31/2010

Crash Route: IL050 | From MileStation 33.41 to 33.41 | County : Cook | Intersection Related: Intersections | *See Notes at End of Report.

| Date | Weather | Roadway | ----- A | Injuries B | ----- C | Killed | Type of Crash | Light Condition | Mile | Vehicle Type | DIRP | Maneuver | Event 1 | Loc 1 | Event 2 | Loc 2 | Event 3 | Loc 3 | Unit |
|---------------------|---------|---------|------------|---------------|------------|--------|---------------|-----------------------|-------|-----------------------------|-------|------------------------|--------------------------|-----------------------|---------------------|---------------------|---------|-------|------|
| 201001033026 | | | | | | | | | | | | | | | | | | | |
| 1/6/2010 12:52 PM | Clear | Dry | 0 | 1 | 0 | 0 | 15-Angle | Daylight | 33.41 | Passenger | West | Straight ahead | Motor vehicle in traffic | On-pavement (roadway) | (UNK) | (UNK) | (UNK) | (UNK) | 1 |
| | | | | | | | | | | Other | North | Slow/stop – right turn | Motor vehicle in traffic | On-pavement (roadway) | (UNK) | (UNK) | (UNK) | (UNK) | 2 |
| 201001052205 | | | | | | | | | | | | | | | | | | | |
| 1/24/2010 4:05 PM | Rain | Wet | 0 | 0 | 1 | 0 | 11-Rear end | Daylight | 33.41 | Passenger | South | Slow/stop in traffic | Motor vehicle in traffic | On-pavement (roadway) | (UNK) | (UNK) | (UNK) | (UNK) | 1 |
| | | | | | | | | | | Passenger | South | Slow/stop in traffic | Motor vehicle in traffic | On-pavement (roadway) | (UNK) | (UNK) | (UNK) | (UNK) | 2 |
| 201001061574 | | | | | | | | | | | | | | | | | | | |
| 2/4/2010 7:01 PM | Clear | Dry | 0 | 0 | 0 | 0 | 15-Angle | Darkness/Lighted road | 33.41 | Passenger | West | Straight ahead | Motor vehicle in traffic | Intersection | (UNK) | (UNK) | (UNK) | (UNK) | 1 |
| | | | | | | | | | | Sport utility vehicle (SUV) | North | Straight ahead | Motor vehicle in traffic | Intersection | (UNK) | (UNK) | (UNK) | (UNK) | 2 |
| 201001243221 | | | | | | | | | | | | | | | | | | | |
| 7/17/2010 7:10 PM | Clear | Dry | 0 | 1 | 1 | 0 | 11-Rear end | Daylight | 33.41 | Pickup | West | Straight ahead | Motor vehicle in traffic | On-pavement (roadway) | (UNK) | (UNK) | (UNK) | (UNK) | 1 |
| | | | | | | | | | | Passenger | West | Slow/stop in traffic | Motor vehicle in traffic | On-pavement (roadway) | (UNK) | (UNK) | (UNK) | (UNK) | 2 |
| 201001344136 | | | | | | | | | | | | | | | | | | | |
| 10/2/2010 11:35 AM | Rain | Wet | 0 | 0 | 5 | 0 | 11-Rear end | Daylight | 33.41 | Van/mini van | South | Straight ahead | Motor vehicle in traffic | Intersection | (UNK) | (UNK) | (UNK) | (UNK) | 1 |
| | | | | | | | | | | Sport utility vehicle (SUV) | South | Slow/stop – left turn | Motor vehicle in traffic | Intersection | Ran off the roadway | Off pavement - left | (UNK) | (UNK) | 2 |

Collision Diagram

1/1/2010 to 12/31/2010

Crash Route: IL050 | From MileStation 33.41 to 33.41 | County : Cook | Intersection Related: Intersections | *See Notes at End of Report.

| Date | Weather | Roadway | ----- A | Injuries B | ----- C | Killed | Type of Crash | Light Condition | Mile | Vehicle Type | DIRP | Maneuver | Event 1 | Loc 1 | Event 2 | Loc 2 | Event 3 | Loc 3 | Unit |
|---------------------|---------|---------|------------|---------------|------------|--------|---------------|-----------------------|-------|-----------------------------|-------|----------------|--------------------------|-----------------------|---------|-------|---------|-------|------|
| 201001377638 | | | | | | | | | | | | | | | | | | | |
| 10/21/2010 7:10 PM | Clear | Dry | 0 | 0 | 1 | 0 | 10-Turning | Darkness/Lighted road | 33.41 | Passenger | West | Turning left | Motor vehicle in traffic | On-pavement (roadway) | (UNK) | (UNK) | (UNK) | (UNK) | 1 |
| | | | | | | | | | | Sport utility vehicle (SUV) | West | Turning left | Motor vehicle in traffic | On-pavement (roadway) | (UNK) | (UNK) | (UNK) | (UNK) | 2 |
| 201001414146 | | | | | | | | | | | | | | | | | | | |
| 11/24/2010 10:35 PM | Rain | Wet | 0 | 0 | 0 | 0 | 11-Rear end | Darkness/Lighted road | 33.41 | Passenger | North | Straight ahead | Motor vehicle in traffic | On-pavement (roadway) | (UNK) | (UNK) | (UNK) | (UNK) | 1 |
| | | | | | | | | | | Passenger | North | Straight ahead | Motor vehicle in traffic | On-pavement (roadway) | (UNK) | (UNK) | (UNK) | (UNK) | 2 |

Collision Diagram

1/1/2010 to 12/31/2010

Crash Route: IL050 | From MileStation 33.41 to 33.41 | County : Cook | Intersection Related: Intersections | *See Notes at End of Report.

| TOTAL CRASHES | FATAL CRASHES | A INJURY CRASHES | B INJURY CRASHES | C INJURY CRASHES | PROPERTY DAMAGE CRASHES | TOTAL KILLED | TOTAL INJURED | A INJURIES | B INJURIES | C INJURIES |
|---------------|---------------|------------------|------------------|------------------|-------------------------|--------------|---------------|------------|------------|------------|
| 7 | 0 | 0 | 2 | 3 | 2 | 0 | 10 | 0 | 2 | 8 |

| Type of Crash | Total | % | Day of Wk | Total | % | Hour of Day | Total | % | Vehicle Type | Total | % |
|---------------|----------|-------|---------------|----------|-------|---------------|----------|-------|-----------------------------|-----------|-------|
| 10-Turning | 1 | 14.3% | Wednesday | 2 | 28.6% | 11 AM | 1 | 14.3% | Other | 1 | 7.1% |
| 11-Rear end | 4 | 57.1% | Thursday | 2 | 28.6% | Noon | 1 | 14.3% | Passenger | 8 | 57.1% |
| 15-Angle | 2 | 28.6% | Saturday | 2 | 28.6% | 4 PM | 1 | 14.3% | Pickup | 1 | 7.1% |
| TOTAL: | 7 | | Sunday | 1 | 14.3% | 7 PM | 3 | 42.9% | Sport utility vehicle (SUV) | 3 | 21.4% |
| | | | TOTAL: | 7 | | 10 PM | 1 | 14.3% | Van/mini van | 1 | 7.1% |
| | | | | | | TOTAL: | 7 | | TOTAL: | 14 | |

| Weather Cond | Total | % | Light Cond | Total | % | Road Surface | Total | % | DIRP | Total | % |
|---------------|----------|-------|-----------------------|----------|-------|---------------|----------|-------|---------------|-----------|-------|
| Clear | 4 | 57.1% | Darkness/Lighted road | 3 | 42.9% | Dry | 4 | 57.1% | North | 4 | 28.6% |
| Rain | 3 | 42.9% | Daylight | 4 | 57.1% | Wet | 3 | 42.9% | South | 4 | 28.6% |
| TOTAL: | 7 | | TOTAL: | 7 | | TOTAL: | 7 | | West | 6 | 42.9% |
| | | | | | | | | | TOTAL: | 14 | |



Collision Diagram

1/1/2010 to 12/31/2010

Crash Route: IL050 | From MileStation 33.41 to 33.41 | County : Cook | Intersection Related: Intersections | *See Notes at End of Report.

Notes

Current year and previous year data are not yet complete and are subject to change as more information becomes available. Calendar date selections include data based on the date of the crash. Year selections include data based on the statistical year in which the crash was processed.

The intersection-related field could be incorrect and affect the data on the report.

If a crash occurs between two municipalities, it may be coded to another city/county from what is on the crash report.

Crashes with incomplete location information are not included.

Areas where routes have more than one junction have been known to cause problems in determining accurate locations. Please notify us to verify the data for intersections with more than one junction.

For roadway segments which include the intersection of two routes, the intersection report may need to be run on the other route in order to get all the crashes.

Collision Diagram

1/1/2009 to 12/31/2009

Crash Route: IL050 | From MileStation 33.41 to 33.41 | County : Cook | Intersection Related: Intersections | *See Notes at End of Report.

| Date | Weather | Roadway | ----- A | Injuries B | ----- C | Killed | Type of Crash | Light Condition | Mile | Vehicle Type | DIRP | Maneuver | Event 1 | Loc 1 | Event 2 | Loc 2 | Event 3 | Loc 3 | Unit |
|---------------------|---------|---------|------------|---------------|------------|--------|---------------|-----------------------|-------|-----------------------------|-------|-----------------------|--------------------------|-----------------------|---------|-------|---------|-------|------|
| 200901184562 | | | | | | | | | | | | | | | | | | | |
| 5/12/2009 2:53 PM | Clear | Dry | 0 | 2 | 0 | 0 | 11-Rear end | Daylight | 33.41 | Passenger | East | Straight ahead | Motor vehicle in traffic | On-pavement (roadway) | (UNK) | (UNK) | (UNK) | (UNK) | 1 |
| | | | | | | | | | | Passenger | East | Straight ahead | Motor vehicle in traffic | On-pavement (roadway) | (UNK) | (UNK) | (UNK) | (UNK) | 2 |
| 200901260973 | | | | | | | | | | | | | | | | | | | |
| 7/7/2009 12:35 PM | Clear | Dry | 0 | 0 | 0 | 0 | 11-Rear end | Daylight | 33.41 | Sport utility vehicle (SUV) | West | Straight ahead | Motor vehicle in traffic | Intersection | (UNK) | (UNK) | (UNK) | (UNK) | 1 |
| | | | | | | | | | | Van/mini van | West | Slow/stop in traffic | Motor vehicle in traffic | Intersection | (UNK) | (UNK) | (UNK) | (UNK) | 2 |
| 200901269690 | | | | | | | | | | | | | | | | | | | |
| 7/25/2009 4:38 PM | Clear | Dry | 2 | 0 | 0 | 0 | 11-Rear end | Daylight | 33.41 | Passenger | East | Straight ahead | Motor vehicle in traffic | On-pavement (roadway) | (UNK) | (UNK) | (UNK) | (UNK) | 1 |
| | | | | | | | | | | Passenger | East | Slow/stop in traffic | Motor vehicle in traffic | On-pavement (roadway) | (UNK) | (UNK) | (UNK) | (UNK) | 2 |
| 200901326772 | | | | | | | | | | | | | | | | | | | |
| 8/27/2009 8:40 PM | Rain | Wet | 0 | 0 | 2 | 0 | 10-Turning | Darkness/Lighted road | 33.41 | Sport utility vehicle (SUV) | South | Turning left | Motor vehicle in traffic | Intersection | (UNK) | (UNK) | (UNK) | (UNK) | 1 |
| | | | | | | | | | | Sport utility vehicle (SUV) | North | Straight ahead | Motor vehicle in traffic | Intersection | (UNK) | (UNK) | (UNK) | (UNK) | 2 |
| 200901338544 | | | | | | | | | | | | | | | | | | | |
| 9/22/2009 7:05 AM | Clear | Wet | 0 | 0 | 0 | 0 | 11-Rear end | Daylight | 33.41 | Passenger | South | Other | Motor vehicle in traffic | Intersection | (UNK) | (UNK) | (UNK) | (UNK) | 1 |
| | | | | | | | | | | Sport utility vehicle (SUV) | South | Skidding/control loss | Motor vehicle in traffic | Intersection | (UNK) | (UNK) | (UNK) | (UNK) | 2 |

Collision Diagram

1/1/2009 to 12/31/2009

Crash Route: IL050 | From MileStation 33.41 to 33.41 | County : Cook | Intersection Related: Intersections | *See Notes at End of Report.

| Date | Weather | Roadway | ----- A | Injuries B | ----- C | Killed | Type of Crash | Light Condition | Mile | Vehicle Type | DIRP | Maneuver | Event 1 | Loc 1 | Event 2 | Loc 2 | Event 3 | Loc 3 | Unit |
|---------------------|---------|---------------|------------|---------------|------------|--------|---------------|-----------------------|-------|-----------------------------|-------|----------------------|--------------------------|-----------------------|---------|-------|---------|-------|------|
| 200901388332 | | | | | | | | | | | | | | | | | | | |
| 10/22/2009 5:20 PM | Rain | Wet | 1 | 0 | 1 | 0 | 10-Turning | Dusk | 33.41 | Passenger | East | Turning left | Motor vehicle in traffic | On-pavement (roadway) | (UNK) | (UNK) | (UNK) | (UNK) | 1 |
| | | | | | | | | | | Passenger | North | Straight ahead | Motor vehicle in traffic | On-pavement (roadway) | (UNK) | (UNK) | (UNK) | (UNK) | 2 |
| 200901397213 | | | | | | | | | | | | | | | | | | | |
| 11/4/2009 8:03 AM | Clear | Dry | 0 | 4 | 0 | 0 | 11-Rear end | Daylight | 33.41 | Sport utility vehicle (SUV) | South | Straight ahead | Motor vehicle in traffic | Intersection | (UNK) | (UNK) | (UNK) | (UNK) | 2 |
| | | | | | | | | | | Passenger | South | Straight ahead | Motor vehicle in traffic | Intersection | (UNK) | (UNK) | (UNK) | (UNK) | 3 |
| | | | | | | | | | | Passenger | South | Straight ahead | Motor vehicle in traffic | Intersection | (UNK) | (UNK) | (UNK) | (UNK) | 1 |
| 200901434041 | | | | | | | | | | | | | | | | | | | |
| 11/25/2009 9:40 PM | Rain | Wet | 0 | 2 | 0 | 0 | 11-Rear end | Darkness/Lighted road | 33.41 | Passenger | South | Straight ahead | Motor vehicle in traffic | On-pavement (roadway) | (UNK) | (UNK) | (UNK) | (UNK) | 1 |
| | | | | | | | | | | Sport utility vehicle (SUV) | South | Slow/stop in traffic | Motor vehicle in traffic | On-pavement (roadway) | (UNK) | (UNK) | (UNK) | (UNK) | 2 |
| 200901445348 | | | | | | | | | | | | | | | | | | | |
| 12/8/2009 4:00 PM | Snow | Snow or slush | 0 | 0 | 2 | 0 | 10-Turning | Daylight | 33.41 | Passenger | West | Turning left | Motor vehicle in traffic | Intersection | (UNK) | (UNK) | (UNK) | (UNK) | 1 |
| | | | | | | | | | | Passenger | East | Straight ahead | Motor vehicle in traffic | Intersection | (UNK) | (UNK) | (UNK) | (UNK) | 2 |
| 200901470738 | | | | | | | | | | | | | | | | | | | |
| 12/26/2009 11:16 AM | Snow | Snow or slush | 0 | 0 | 0 | 0 | 10-Turning | Daylight | 33.41 | Passenger | South | Straight ahead | Motor vehicle in traffic | On-pavement (roadway) | (UNK) | (UNK) | (UNK) | (UNK) | 1 |
| | | | | | | | | | | Passenger | South | Turning right | Motor vehicle in traffic | On-pavement (roadway) | (UNK) | (UNK) | (UNK) | (UNK) | 2 |

Collision Diagram

1/1/2009 to 12/31/2009

Crash Route: IL050 | From MileStation 33.41 to 33.41 | County : Cook | Intersection Related: Intersections | *See Notes at End of Report.

| TOTAL CRASHES | FATAL CRASHES | A INJURY CRASHES | B INJURY CRASHES | C INJURY CRASHES | PROPERTY DAMAGE CRASHES | TOTAL KILLED | TOTAL INJURED | A INJURIES | B INJURIES | C INJURIES |
|---------------|---------------|------------------|------------------|------------------|-------------------------|--------------|---------------|------------|------------|------------|
| <u>10</u> | <u>0</u> | <u>2</u> | <u>3</u> | <u>2</u> | <u>3</u> | <u>0</u> | <u>16</u> | <u>3</u> | <u>8</u> | <u>5</u> |

| Type of Crash | Total | % | Day of Wk | Total | % | Hour of Day | Total | % | Vehicle Type | Total | % |
|---------------|-----------|-------|---------------|-----------|-------|---------------|-----------|-------|-----------------------------|-----------|-------|
| 10-Turning | 4 | 40.0% | Tuesday | 4 | 40.0% | 07 AM | 1 | 10.0% | Passenger | 14 | 66.7% |
| 11-Rear end | 6 | 60.0% | Wednesday | 2 | 20.0% | 08 AM | 1 | 10.0% | Sport utility vehicle (SUV) | 6 | 28.6% |
| TOTAL: | 10 | | Thursday | 2 | 20.0% | 11 AM | 1 | 10.0% | Van/mini van | 1 | 4.8% |
| | | | Saturday | 2 | 20.0% | Noon | 1 | 10.0% | TOTAL: | 21 | |
| | | | TOTAL: | 10 | | 2 PM | 1 | 10.0% | | | |
| | | | | | | 4 PM | 2 | 20.0% | | | |
| | | | | | | 5 PM | 1 | 10.0% | | | |
| | | | | | | 8 PM | 1 | 10.0% | | | |
| | | | | | | 9 PM | 1 | 10.0% | | | |
| | | | | | | TOTAL: | 10 | | | | |

| Weather Cond | Total | % | Light Cond | Total | % | Road Surface | Total | % | DIRP | Total | % |
|---------------|-----------|-------|-----------------------|-----------|-------|---------------|-----------|-------|---------------|-----------|-------|
| Clear | 5 | 50.0% | Darkness/Lighted road | 2 | 20.0% | Dry | 4 | 40.0% | East | 6 | 28.6% |
| Rain | 3 | 30.0% | Daylight | 7 | 70.0% | Snow or slush | 2 | 20.0% | North | 2 | 9.5% |
| Snow | 2 | 20.0% | Dusk | 1 | 10.0% | Wet | 4 | 40.0% | South | 10 | 47.6% |
| TOTAL: | 10 | | TOTAL: | 10 | | TOTAL: | 10 | | West | 3 | 14.3% |
| | | | | | | | | | TOTAL: | 21 | |

Collision Diagram

1/1/2009 to 12/31/2009

Crash Route: IL050 | From MileStation 33.41 to 33.41 | County : Cook | Intersection Related: Intersections | *See Notes at End of Report.

Notes

Current year and previous year data are not yet complete and are subject to change as more information becomes available. Calendar date selections include data based on the date of the crash. Year selections include data based on the statistical year in which the crash was processed.

The intersection-related field could be incorrect and affect the data on the report.

If a crash occurs between two municipalities, it may be coded to another city/county from what is on the crash report.

Crashes with incomplete location information are not included.

Areas where routes have more than one junction have been known to cause problems in determining accurate locations. Please notify us to verify the data for intersections with more than one junction.

For roadway segments which include the intersection of two routes, the intersection report may need to be run on the other route in order to get all the crashes.

Collision Diagram

1/1/2008 to 12/31/2008

Crash Route: IL050 | From MileStation 33.35 to 33.35 | County : Cook | Intersection Related: Intersections | *See Notes at End of Report.

| Date | Weather | Roadway | ----- A | Injuries B | ----- C | Killed | Type of Crash | Light Condition | Mile | Vehicle Type | DIRP | Maneuver | Event 1 | Loc 1 | Event 2 | Loc 2 | Event 3 | Loc 3 | Unit |
|-------------------|---------|---------------|------------|---------------|------------|--------|-----------------------------|-----------------------|-------|-----------------------------|-------|---------------------------|--------------------------|-----------------------|---------|-------|---------|-------|------|
| 80152150 | | | | | | | | | | | | | | | | | | | |
| 1/4/2008 6:18 PM | Clear | Dry | 0 | 0 | 0 | 0 | 12-Sideswipe same direction | Darkness/Lighted road | 33.35 | Passenger | South | Straight ahead | Motor vehicle in traffic | On-pavement (roadway) | (UNK) | (UNK) | (UNK) | (UNK) | 2 |
| | | | | | | | | | | Passenger | South | Changing lanes | Motor vehicle in traffic | On-pavement (roadway) | (UNK) | (UNK) | (UNK) | (UNK) | 1 |
| 80255979 | | | | | | | | | | | | | | | | | | | |
| 1/14/2008 5:00 PM | Snow | Snow or slush | 0 | 0 | 0 | 0 | 10-Turning | Daylight | 33.35 | Sport utility vehicle (SUV) | West | Turning right | Motor vehicle in traffic | Intersection | (UNK) | (UNK) | (UNK) | (UNK) | 1 |
| | | | | | | | | | | Passenger | East | Straight ahead | Motor vehicle in traffic | Intersection | (UNK) | (UNK) | (UNK) | (UNK) | 2 |
| 80264534 | | | | | | | | | | | | | | | | | | | |
| 1/25/2008 5:45 PM | Snow | Snow or slush | 0 | 0 | 0 | 0 | 11-Rear end | Darkness/Lighted road | 33.35 | Passenger | North | Avoiding vehicles/objects | Motor vehicle in traffic | On-pavement (roadway) | (UNK) | (UNK) | (UNK) | (UNK) | 1 |
| | | | | | | | | | | Passenger | North | Slow/stop in traffic | Motor vehicle in traffic | On-pavement (roadway) | (UNK) | (UNK) | (UNK) | (UNK) | 2 |
| 80557176 | | | | | | | | | | | | | | | | | | | |
| 2/22/2008 7:00 PM | Snow | Snow or slush | 0 | 0 | 0 | 0 | 10-Turning | Darkness | 33.35 | Passenger | North | Turning left | Motor vehicle in traffic | Intersection | (UNK) | (UNK) | (UNK) | (UNK) | 1 |
| | | | | | | | | | | Sport utility vehicle (SUV) | North | Turning right | Motor vehicle in traffic | Intersection | (UNK) | (UNK) | (UNK) | (UNK) | 2 |
| 81295388 | | | | | | | | | | | | | | | | | | | |
| 4/2/2008 8:12 AM | Clear | Dry | 0 | 0 | 0 | 0 | 11-Rear end | Daylight | 33.35 | Passenger | North | Slow/stop in traffic | Motor vehicle in traffic | On-pavement (roadway) | (UNK) | (UNK) | (UNK) | (UNK) | 1 |
| | | | | | | | | | | Sport utility vehicle (SUV) | North | Slow/stop in traffic | Motor vehicle in traffic | On-pavement (roadway) | (UNK) | (UNK) | (UNK) | (UNK) | 2 |

Collision Diagram

1/1/2008 to 12/31/2008

Crash Route: IL050 | From MileStation 33.35 to 33.35 | County : Cook | Intersection Related: Intersections | *See Notes at End of Report.

| Date | Weather | Roadway | ----- A | Injuries B | ----- C | Killed | Type of Crash | Light Condition | Mile | Vehicle Type | DIRP | Maneuver | Event 1 | Loc 1 | Event 2 | Loc 2 | Event 3 | Loc 3 | Unit |
|--------------------|---------|---------|------------|---------------|------------|--------|---------------|-----------------|-------|-----------------------------|-------|-----------------------|--------------------------|-----------------------|--------------------------|--------------|---------|-------|------|
| 81709297 | | | | | | | | | | | | | | | | | | | |
| 4/27/2008 8:02 PM | Clear | Dry | 0 | 2 | 0 | 0 | 10-Turning | Darkness | 33.35 | Passenger | North | Turning right | Motor vehicle in traffic | Intersection | (UNK) | (UNK) | (UNK) | (UNK) | 1 |
| | | | | | | | | | | Sport utility vehicle (SUV) | North | Straight ahead | Motor vehicle in traffic | Intersection | Motor vehicle in traffic | Intersection | (UNK) | (UNK) | 2 |
| | | | | | | | | | | Passenger | East | Slow/stop – left turn | Motor vehicle in traffic | Intersection | (UNK) | (UNK) | (UNK) | (UNK) | 3 |
| 82026998 | | | | | | | | | | | | | | | | | | | |
| 5/29/2008 10:41 PM | Clear | Dry | 0 | 1 | 0 | 0 | 10-Turning | Darkness | 33.35 | Passenger | South | Turning left | Motor vehicle in traffic | Intersection | (UNK) | (UNK) | (UNK) | (UNK) | 1 |
| | | | | | | | | | | Passenger | North | Straight ahead | Motor vehicle in traffic | Intersection | (UNK) | (UNK) | (UNK) | (UNK) | 2 |
| 82027004 | | | | | | | | | | | | | | | | | | | |
| 5/30/2008 2:50 PM | Rain | Wet | 0 | 0 | 0 | 0 | 10-Turning | Daylight | 33.35 | Passenger | North | Straight ahead | Motor vehicle in traffic | On-pavement (roadway) | (UNK) | (UNK) | (UNK) | (UNK) | 1 |
| | | | | | | | | | | Van/mini van | South | Turning left | Motor vehicle in traffic | On-pavement (roadway) | (UNK) | (UNK) | (UNK) | (UNK) | 2 |
| 82222910 | | | | | | | | | | | | | | | | | | | |
| 6/17/2008 4:20 PM | Clear | Dry | 0 | 0 | 0 | 0 | 15-Angle | Daylight | 33.35 | Passenger | North | Straight ahead | Motor vehicle in traffic | On-pavement (roadway) | (UNK) | (UNK) | (UNK) | (UNK) | 1 |
| | | | | | | | | | | Passenger | East | Straight ahead | Motor vehicle in traffic | On-pavement (roadway) | (UNK) | (UNK) | (UNK) | (UNK) | 2 |
| 83405498 | | | | | | | | | | | | | | | | | | | |
| 8/26/2008 12:29 PM | Clear | Dry | 0 | 1 | 0 | 0 | 10-Turning | Daylight | 33.35 | Other | East | Turning left | Motor vehicle in traffic | Intersection | (UNK) | (UNK) | (UNK) | (UNK) | 1 |
| | | | | | | | | | | Passenger | North | Straight ahead | Motor vehicle in traffic | Intersection | (UNK) | (UNK) | (UNK) | (UNK) | 2 |

Collision Diagram

1/1/2008 to 12/31/2008

Crash Route: IL050 | From MileStation 33.35 to 33.35 | County : Cook | Intersection Related: Intersections | *See Notes at End of Report.

| Date | Weather | Roadway | ----- A | Injuries B | ----- C | Killed | Type of Crash | Light Condition | Mile | Vehicle Type | DIRP | Maneuver | Event 1 | Loc 1 | Event 2 | Loc 2 | Event 3 | Loc 3 | Unit |
|--------------------|---------|---------|------------|---------------|------------|--------|---------------|--------------------------|-------|--------------|-------|-------------------|--------------------------------|------------------------------|---------|-------|---------|-------|------|
| | | | | | | | | | | Passenger | West | Unknown/N A | Motor vehicle in traffic | Intersectio n | (UNK) | (UNK) | (UNK) | (UNK) | 3 |
| 84426824 | | | | | | | | | | | | | | | | | | | |
| 11/12/2008 5:46 PM | Rain | Wet | 0 | 0 | 0 | 0 | 11-Rear end | Darkness/Lighted road | 33.35 | | | | | | | | | | |
| | | | | | | | | | | Passenger | North | Other | Motor vehicle in traffic | On- pavement (roadway) | (UNK) | (UNK) | (UNK) | (UNK) | 1 |
| | | | | | | | | | | Passenger | North | Straight ahead | Motor vehicle in traffic | On- pavement (roadway) | (UNK) | (UNK) | (UNK) | (UNK) | 2 |
| 84551324 | | | | | | | | | | | | | | | | | | | |
| 11/20/2008 8:52 PM | Clear | Dry | 0 | 0 | 1 | 0 | 15-Angle | Darkness/Lighted road | 33.35 | | | | | | | | | | |
| | | | | | | | | | | Passenger | West | Straight ahead | Motor vehicle in traffic | Intersectio n | (UNK) | (UNK) | (UNK) | (UNK) | 1 |
| | | | | | | | | | | Van/mini van | North | Straight ahead | Motor vehicle in traffic | Intersectio n | (UNK) | (UNK) | (UNK) | (UNK) | 2 |

Collision Diagram

1/1/2008 to 12/31/2008

Crash Route: IL050 | From MileStation 33.35 to 33.35 | County : Cook | Intersection Related: Intersections | *See Notes at End of Report.

| TOTAL CRASHES | FATAL CRASHES | A INJURY CRASHES | B INJURY CRASHES | C INJURY CRASHES | PROPERTY DAMAGE CRASHES | TOTAL KILLED | TOTAL INJURED | A INJURIES | B INJURIES | C INJURIES |
|---------------|---------------|------------------|------------------|------------------|-------------------------|--------------|---------------|------------|------------|------------|
| 12 | 0 | 0 | 3 | 1 | 8 | 0 | 5 | 0 | 4 | 1 |

| Type of Crash | Total | % | Day of Wk | Total | % | Hour of Day | Total | % | Vehicle Type | Total | % |
|-----------------------------|-----------|-------|---------------|-----------|-------|---------------|-----------|-------|-----------------------------|-----------|-------|
| 10-Turning | 6 | 50.0% | Monday | 1 | 8.3% | 08 AM | 1 | 8.3% | Other | 1 | 3.8% |
| 11-Rear end | 3 | 25.0% | Tuesday | 2 | 16.7% | Noon | 1 | 8.3% | Passenger | 19 | 73.1% |
| 12-Sideswipe same direction | 1 | 8.3% | Wednesday | 2 | 16.7% | 2 PM | 1 | 8.3% | Sport utility vehicle (SUV) | 4 | 15.4% |
| 15-Angle | 2 | 16.7% | Thursday | 2 | 16.7% | 4 PM | 1 | 8.3% | Van/mini van | 2 | 7.7% |
| TOTAL: | 12 | | Friday | 4 | 33.3% | 5 PM | 3 | 25.0% | TOTAL: | 26 | |
| | | | Sunday | 1 | 8.3% | 6 PM | 1 | 8.3% | | | |
| | | | TOTAL: | 12 | | 7 PM | 1 | 8.3% | | | |
| | | | | | | 8 PM | 2 | 16.7% | | | |
| | | | | | | 10 PM | 1 | 8.3% | | | |
| | | | | | | TOTAL: | 12 | | | | |

| Weather Cond | Total | % | Light Cond | Total | % | Road Surface | Total | % | DIRP | Total | % |
|---------------|-----------|-------|-----------------------|-----------|-------|---------------|-----------|-------|---------------|-----------|-------|
| Clear | 7 | 58.3% | Darkness | 3 | 25.0% | Dry | 7 | 58.3% | East | 4 | 15.4% |
| Rain | 2 | 16.7% | Darkness/Lighted road | 4 | 33.3% | Snow or slush | 3 | 25.0% | North | 15 | 57.7% |
| Snow | 3 | 25.0% | Daylight | 5 | 41.7% | Wet | 2 | 16.7% | South | 4 | 15.4% |
| TOTAL: | 12 | | TOTAL: | 12 | | TOTAL: | 12 | | West | 3 | 11.5% |
| | | | | | | | | | TOTAL: | 26 | |



Collision Diagram

1/1/2008 to 12/31/2008

Crash Route: IL050 | From MileStation 33.35 to 33.35 | County : Cook | Intersection Related: Intersections | *See Notes at End of Report.

Notes

Current year and previous year data are not yet complete and are subject to change as more information becomes available. Calendar date selections include data based on the date of the crash. Year selections include data based on the statistical year in which the crash was processed.

The intersection-related field could be incorrect and affect the data on the report.

If a crash occurs between two municipalities, it may be coded to another city/county from what is on the crash report.

Crashes with incomplete location information are not included.

Areas where routes have more than one junction have been known to cause problems in determining accurate locations. Please notify us to verify the data for intersections with more than one junction.

For roadway segments which include the intersection of two routes, the intersection report may need to be run on the other route in order to get all the crashes.

Traffic Volume

September 2008

The traffic numbers below were obtained from the IDOT website per the RLR Guideline document published by IDOT. Only ADT values were available, peak numbers were not provided.

Cicero Ave (IL Route 50) ADT

- North: 18,800
- South: 16,600

183rd St ADT

- East: 16,500
- West: 9,100

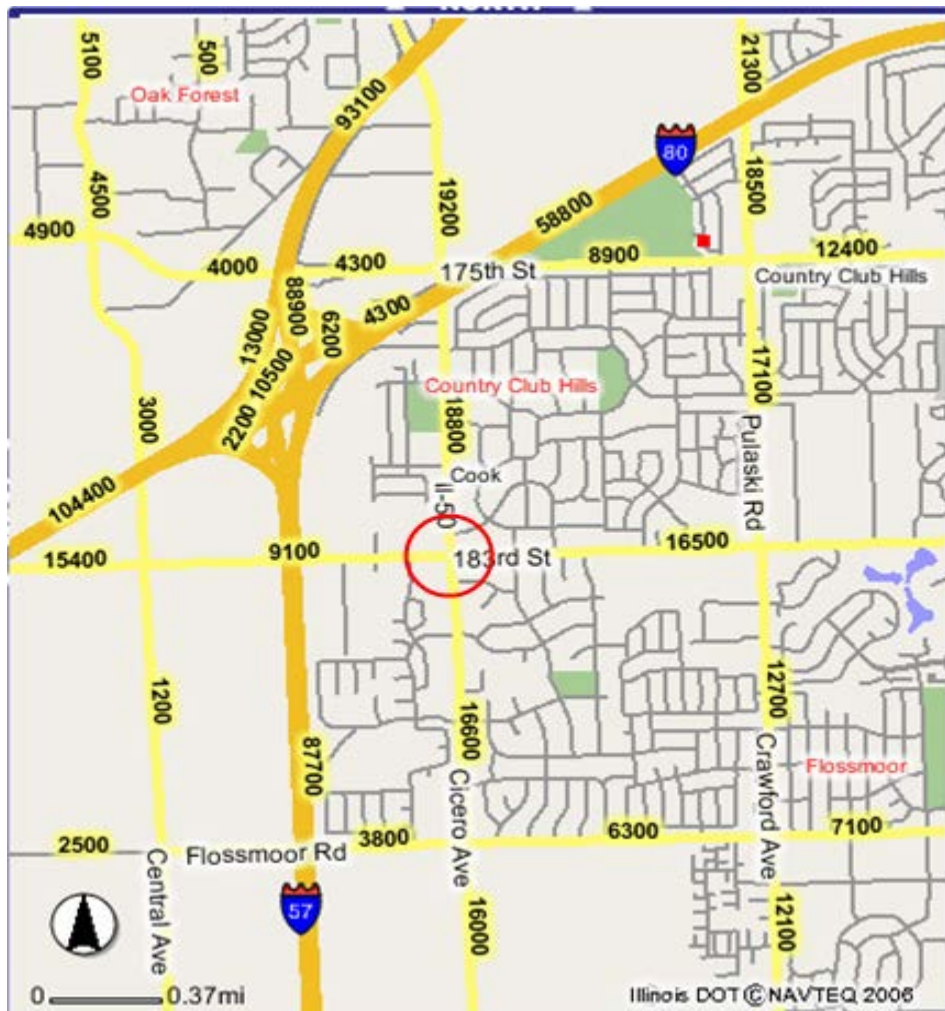

January 2010

The traffic numbers below were obtained from the IDOT website per the RLR Guideline document published by IDOT. Only ADT values were available, peak numbers were not provided.

Cicero Ave (IL Route 50) ADT

- North: 16,800
- South: 14,600

183rd St ADT

- East: 16,500
- West: 9,100

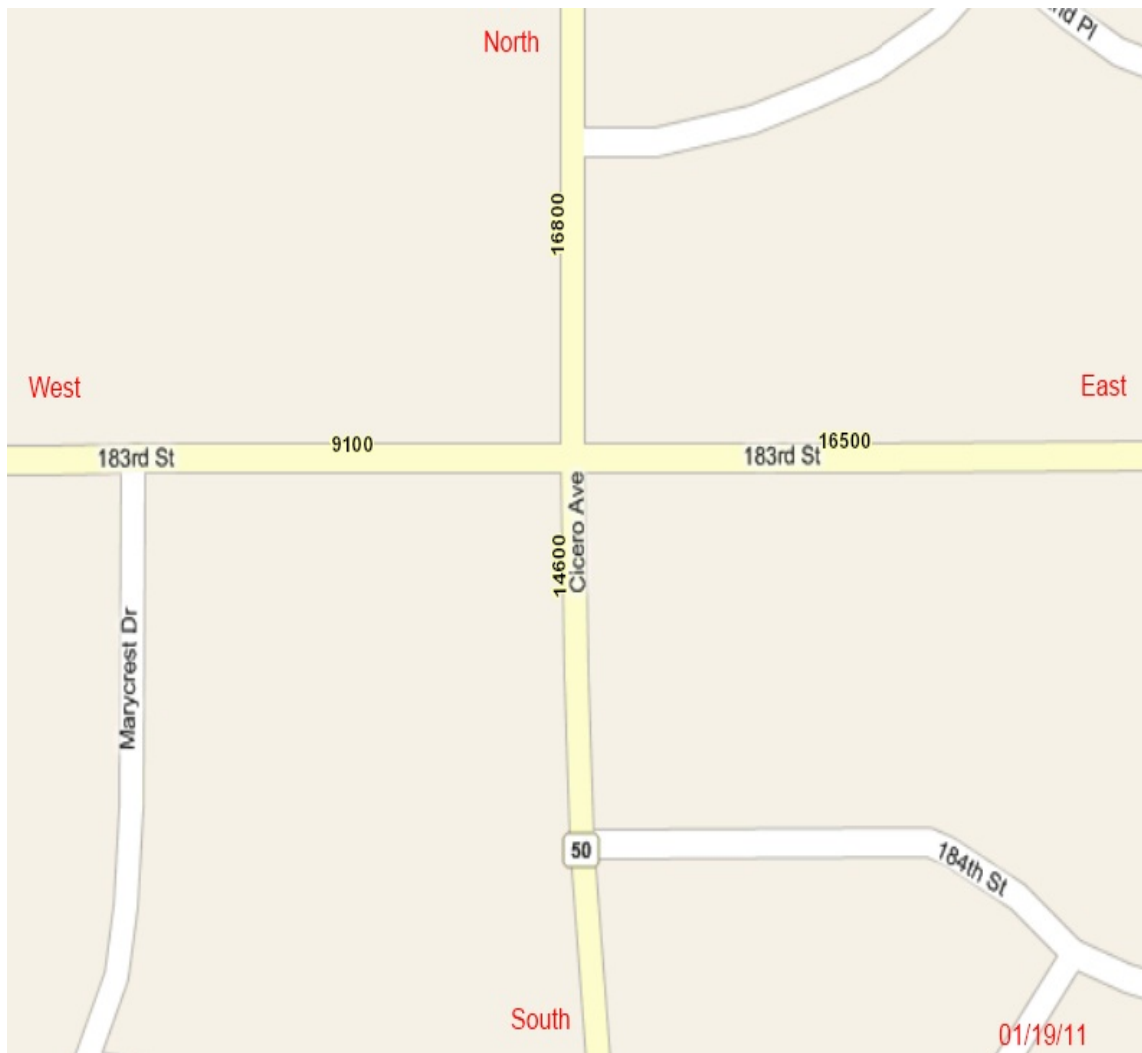

December 2013

The traffic numbers below were obtained from the IDOT website per the RLR Guideline document published by IDOT. Only ADT values were available, peak numbers were not provided.

Cicero Ave (IL Route 50) ADT

- North: 14,500
- South: 14,600

183rd St ADT

- East: 18,600
- West: 8,200

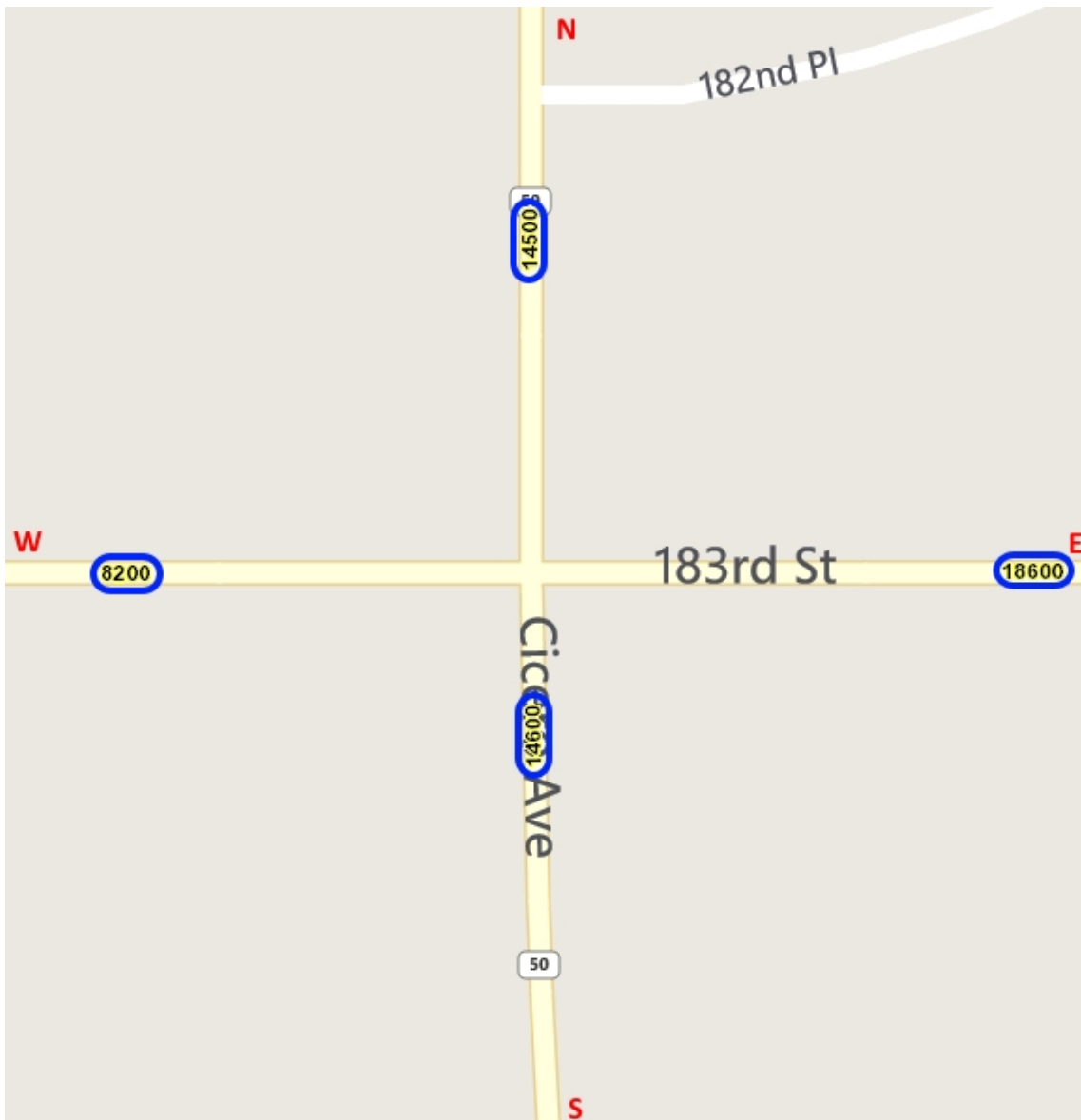

Summary

All processes are in compliance with the RLR regulations laid out by the Illinois Department of Transportation District 1 Bureau of Traffic Operations.

After analyzing all of the available data, we believe that the RLR cameras currently in operation at the intersection of 183rd St and Cicero Ave in the **City of Country Club Hills** are making a contribution toward improved traffic safety at this location. Total crashes have been reduced by 51.7% since the RLR cameras were installed. This reduction has occurred in spite of fluctuations in traffic volume over a 6 year period. These cameras play an important role in monitoring the intersection and encourage safe driving habits.