

IL Route 50 at 183rd Street

<Northbound and Southbound>

RLR Crash Data and Analysis

The table and chart below show the summary of Crash Data at the Northbound and Southbound approaches of the intersection of IL Route 50 and 183rd Street. This includes 3 years of crash data (2006 – 2008) prior to RLR camera installation August, 2009 as well as post period crash data (2010).

US Rt. 50 & 183rd Street (Country Club Hills)

	Angle	Rear End	Other Object	Pedal cyclist	Sideswipe Same direction	Turning	Total
2006	1	3	1	1	0	5	11
2007	2	2	2	1	1	8	16
2008	2	3	0	0	1	6	12
2009	0	6	0	0	0	4	10
2010	2	4	0	0	0	1	7

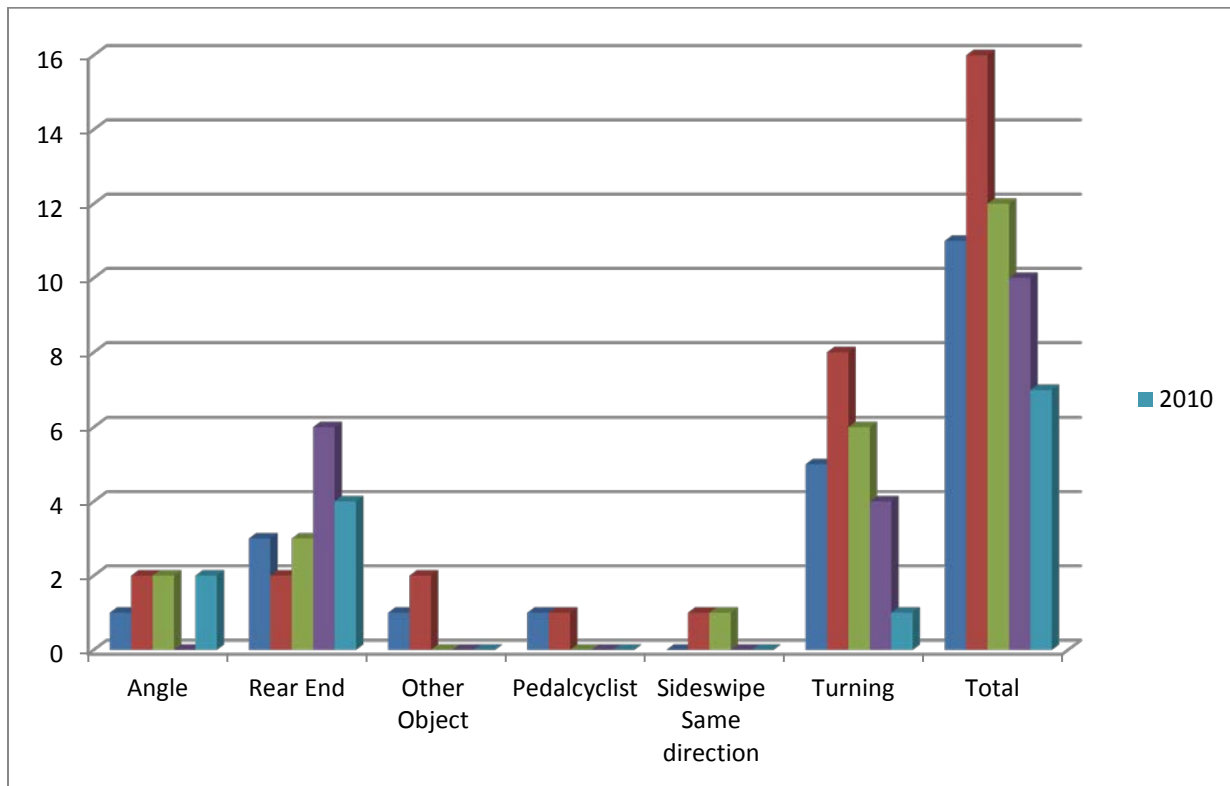

The above results show **Turning accidents** were reduced by **83.33%** (6 to 1) and **Total accidents** were reduced by **41.67%** (12 to 7) at this intersection from year 2008 to year 2010.

In following pages, you will find the crash data from 2006 to 2010 that we acquired from IDOT.

IL Department of Transportation --- Div of Traffic Safety
Collision Diagram Report

Database: CISReports
07/11/2008
Page 1 of 3

01/01/2006 to 12/31/2006
Route: 5050 From MileStation 33.35 to 33.35
County: COOK
Intersection Related

Date	Weather	Roadway	Injuries			Killed	Type of Crash	Light Condition	Mile	Vehicle Type	DIRP	Maneuver	Event 1	Loc1	Event 2	Loc2	Event 3	Loc3	UNIT
			A	B	C														
60204165 1/2/06 1:21 am	Rain	Unknown	0	0	0	0	Angle	Darkness, Lighted Road	33.35	Passenger	N	Straight Ahead	Motor Vehicle in Traffic	4					1
60204211 1/2/05 12:25 pm	Clear	Wet	0	1	1	0	Turning	Daylight	33.35	Passenger	NE	Turning Left	Motor Vehicle in Traffic	4					1
60875069 3/25/06 12:35 pm	Clear	Dry	0	0	1	0	Pedalcyclist	Daylight	33.35	Passenger	N	Straight Ahead	Pedalcyclist	4					2
61073995 4/14/06 6:29 am	Clear	Dry	0	0	0	0	Rear end	Dawn	33.35	Van/Mini-Van	S	Straight Ahead	Motor Vehicle in Traffic	1					1
62268313 5/30/05 7:05 pm	Rain	Wet	0	0	0	0	Fixed object	Daylight	33.35	Passenger	N	Straight Ahead	Motor Vehicle in Traffic	1					2
62662879 7/5/06 9:37 pm	Clear	Dry	0	0	0	0	Turning	Darkness, Lighted Road	33.35	Passenger	SE	Turning Left	Ran Off Roadway	4	Traffic Signal				1
62823238 7/20/06 6:19 am	Rain	Wet	0	0	2	0	Turning	Daylight	33.35	Van/Mini-Van	E	Turning Left	Motor Vehicle in Traffic	1					1
										Passenger	N	Straight Ahead	Motor Vehicle in Traffic	1					2

IL Department of Transportation --- Div of Traffic Safety
Collision Diagram Report

Database: CISReports
07/11/2008
Page 3 of 3

01/01/2006 to 12/31/2006

Route: 5050 From MileStation 33.35 to 33.35

County: COOK

Intersection Related

TOTAL	FATAL	INJURY	PROPERTY DAMAGE	TOTAL KILLED	TOTAL INJURED	A	B	C
11	0	4	7	0	7	0	3	4

Type of Crash	Total	%	Day of Week	Total	%	Hour of Day	Total	%	Vehicle Type	Total	%
Angle	1	9.09%	Monday	2	18.18%	1 AM	1	9.09%	Passenger	16	76.19%
Fixed object	1	9.09%	Tuesday	2	18.18%	6 AM	2	18.18%	Pickup	1	4.76%
Pedalcyclist	1	9.09%	Wednesday	1	9.09%	Noon	3	27.27%	Van/Mini-Van	4	19.05%
Rear end	3	27.27%	Thursday	2	18.18%	5 PM	1	9.09%			
Turning	5	45.45%	Friday	1	9.09%	7 PM	2	18.18%			
			Saturday	3	27.27%	9 PM	2	18.18%			
TOTAL:	11		TOTAL:	11		TOTAL:	11		TOTAL:	21	
Weather Cond	Total	%	Light Cond	Total	%	Road Surface	Total	%	Vehicle DIR	Total	%
Clear	6	54.55%	Darkness, Lighted Road	3	27.27%	Dry	5	45.4	East	2	9.52%
Rain	5	45.45%	Dawn	1	9.09%	Unknown	1	9.0	North	11	52.38%
			Daylight	7	63.64%	Wet	5	45.4	Northeast	2	9.52%
TOTAL:	11		TOTAL:	11		TOTAL:	11		South	2	9.52%
									Southeast	2	9.52%
									West	2	9.52%
									TOTAL:	21	

IL Department of Transportation -- Div of Traffic Safety
Collision Diagram Report

Database: CISReports
07/11/2008
Page 1 of 4

01/01/2007 to 12/31/2007

Route: 5050 From MileStation 33.35 to 33.35
County: COOK

Intersection Related

Date	Weather	Roadway	Injuries			Killed	Type of Crash	Light Condition	Mile	Vehicle Type	DIRP	Maneuver	Event 1	Loc1	Event 2	Loc2	Event 3	Loc3	UNIT
			A	B	C														
70203930																			
1/20/07 9:45 pm	Clear	Dry	0	0	0	0	Turning	Darkness, Lighted Road	33.35	Passenger	SE	Turning Left	Motor Vehicle in Traffic	1					1
											N	Straight Ahead	Motor Vehicle in Traffic	1					2
											W	Slow/Stop in Traffic	Motor Vehicle in Traffic	1					3
70176288																			
1/19/07 6:15 am	Clear	Wet	0	2	0	0	Turning	Daylight	33.35	Passenger	N	Turning Left	Motor Vehicle in Traffic	1					1
											W	Straight Ahead	Motor Vehicle in Traffic	1					2
											S	Unknown	Motor Vehicle in Traffic	1					3
70084987																			
1/19/07 7:20 am	Clear	Dry	0	0	0	0	Turning	Daylight	33.35	SUV	NW	Turning Left	Motor Vehicle in Traffic	4					1
											SW	Turning Right	Motor Vehicle in Traffic	4					2
70665534																			
2/9/07 5:36 pm	Clear	Unknown	0	0	0	0	Rear end	Daylight	33.35	SUV	W	Straight Ahead	Motor Vehicle in Traffic	4					1
											W	Slow/Stop in Traffic	Motor Vehicle in Traffic	4					2
70665799																			
2/14/07 10:34 am	Snow	Snow on Slush	0	0	0	0	Fixed object	Daylight	33.35	SUV	NE	Turning Left	Ran Off Roadway	3					3
71042956																			
3/7/07 7:00 pm	Rain	Wet	0	0	0	0	Sideswipe same direction	Darkness, Lighted Road	33.35	Van/Mini-Van	N	Unknown	Motor Vehicle in Traffic	1					1
											N	Straight Ahead	Motor Vehicle in Traffic	1					2

IL Department of Transportation --- Div of Traffic Safety
Collision Diagram Report

Database: CISReports
07/11/2008
Page 2 of 4

01/01/2007 to 12/31/2007

Route: 5050 From MileStation 33.35 to 33.35
County: COOK

Intersection Related

Date	Weather	Roadway	Injuries			Killed	Type of Crash	Light Condition	Mile	Vehicle Type	DIRP	Maneuver	Event 1	Loc1	Event 2	Loc2	Event 3	Loc3	UNIT
			A	B	C														
71962971	Clear	Dry	0	1	2	0	Angle	Darkness, Lighted Road	33.35	Passenger	NW	Slidding/Control Loss	Motor Vehicle in Traffic	1					1
72750805	Rain	Wet	0	0	0	0	Turning	Daylight	33.35	Passenger	S	Turning Left	Motor Vehicle in Traffic	4					1
72846967	Clear	Dry	0	0	1	0	Angle	Daylight	33.35	Passenger	W	Straight Ahead	Motor Vehicle in Traffic	4					1
73155283	Clear	Dry	0	0	0	0	Turning	Darkness, Lighted Road	33.35	SUV	W	Straight Ahead	Motor Vehicle in Traffic	9					1
74746050	Rain	Wet	0	0	0	0	Rear end	Daylight	33.35	Passenger	NE	Unknown	Motor Vehicle in Traffic	4					1
74746108	Rain	Wet	0	0	0	0	Fixed object	Daylight	33.35	Passenger	NE	Slow/Stop - Left Turn	Ran Off Roadway	3	Traffic Signal				1

IL Department of Transportation --- Div of Traffic Safety
Collision Diagram Report

Database: CISReports
07/11/2008
Page 3 of 4

01/01/2007 to 12/31/2007

Route: 5050 From MileStation 33.35 to 33.35

County: COOK

Intersection Related

Date	Weather	Roadway	Injuries			Killed	Type of Crash	Light Condition	Mile	Vehicle Type	DIRP	Maneuver	Event 1	Loc1	Event 2	Loc2	Event 3	Loc3	UNIT	
			A	B	C															
74778200																				
11/19/07 2:40 pm	Rain	Wet	0	0	0	0	Turning	Daylight	33.35	Passenger	NE	Turning Left	Motor Vehicle in Traffic	4						1
										Bus over 15 Passengers	S	Slow/Stop in Traffic	Motor Vehicle in Traffic	4						2
75147777																				
12/21/07 8:00 am	Rain	Wet	0	4	1	0	Turning	Daylight	33.35	Passenger	SE	Turning Left	Motor Vehicle in Traffic	1						1
										Passenger	N	Straight Ahead	Motor Vehicle in Traffic	1						2
										Passenger	W	Unknown	Motor Vehicle in Traffic	1						3
										Passenger	W	Unknown	Motor Vehicle in Traffic	4						4
75148054																				
12/28/07 11:37 pm	Clear	Wet	0	0	0	0	Turning	Darkness, Lighted Road	33.35	Passenger	SW	Turning Left	Motor Vehicle in Traffic	1						1
										Passenger	E	Straight Ahead	Motor Vehicle in Traffic	1						2

IL Department of Transportation --- Div of Traffic Safety
Collision Diagram Report

Database: CISReports
07/11/2008
Page 4 of 4

01/01/2007 to 12/31/2007

Route: 5050 From MileStation 33.35 to 33.35

County: COOK

Intersection Related

TOTAL	FATAL	INJURY	PROPERTY DAMAGE	TOTAL KILLED	TOTAL INJURED	A	B	C
16	0	5	11	0	12	0	8	4

Type of Crash	Total	%	Day of Week	Total	%	Hour of Day	Total	%	Vehicle Type	Total	%
Angle	2	12.50%	Monday	4	25.00%	6 AM	1	6.25%	Bus over 15	1	3.03%
Fixed object	2	12.50%	Tuesday	2	12.50%	7 AM	2	12.50%	Passengers		
Pedalcyclist	1	6.25%	Wednesday	4	25.00%	8 AM	1	6.25%	Passenger	23	69.70%
Rear end	2	12.50%	Friday	5	31.25%	10 AM	2	12.50%	SUV	4	12.12%
Sideswipe same direction	1	6.25%	Saturday	1	6.25%	11 AM	1	6.25%	Van/Mini-Van	5	15.15%
Turning	8	50.00%				2 PM	1	6.25%			
						5 PM	1	6.25%			
						7 PM	2	12.50%			
						8 PM	2	12.50%			
						9 PM	1	6.25%			
						11 PM	2	12.50%			
TOTAL:	16		TOTAL:	16		TOTAL:	16		TOTAL:	33	

Weather Cond	Total	%	Light Cond	Total	%	Road Surface	Total	%	Vehicle DIR	Total	%
Clear	9	56.25%	Darkness, Lighted Road	5	31.25%	Dry	6	37.5	East	2	6.06%
Rain	6	37.50%	Daylight	10	62.50%	Snow or Slush	1	6.2	North	7	21.21%
Snow	1	6.25%	Dusk	1	6.25%	Unknown	1	6.2	Northeast	4	12.12%
						Wet	8	50.0	Northwest	2	6.06%
									South	5	15.15%
									Southeast	2	6.06%
									Southwest	2	6.06%
TOTAL:	16		TOTAL:	16		TOTAL:	16		West	9	27.27%
									TOTAL:	33	



Collision Diagram

1/1/2008 to 12/31/2008

Crash Route: IL050 | From Mile Station 33.35 to 33.35 | County: Cook | Intersection Related: Intersections | *See Notes at End of Report.

Date	Weather	Roadway	Injuries A	Injuries B	Injuries C	Killed	Type of Crash	Light Condition	Mile	Vehicle Type	DIRP	Maneuver	Event 1	Loc 1	Event 2	Loc 2	Event 3	Loc 3	Unit	
8178297	Clear	Dry	0	2	0	0	10-Turning	Darkness	33.35	Passenger	North	Turning right	Motor vehicle in n traffic	Intersection	(UNK)	(UNK)	(UNK)	(UNK)	(UNK)	1
4/27/2008 8:02 PM										Sport utility vehicle (SUV)	North	Straight ahead	Motor vehicle in n traffic	Intersection	Motor vehicle in n traffic	Intersection	(UNK)	(UNK)	(UNK)	2
82026998										Passenger	East	Slowstop - left turn	Motor vehicle in n traffic	Intersection	(UNK)	(UNK)	(UNK)	(UNK)	(UNK)	3
5/29/2008 10:41 PM	Clear	Dry	0	1	0	0	10-Turning	Darkness	33.35	Passenger	South	Turning left	Motor vehicle in n traffic	Intersection	(UNK)	(UNK)	(UNK)	(UNK)	(UNK)	1
82027004										Passenger	North	Straight ahead	Motor vehicle in n traffic	Intersection	(UNK)	(UNK)	(UNK)	(UNK)	(UNK)	2
5/30/2008 2:50 PM	Rain	Wet	0	0	0	0	10-Turning	Daylight	33.35	Passenger	North	Straight ahead	Motor vehicle in pavement traffic	On-pavement (roadway)	(UNK)	(UNK)	(UNK)	(UNK)	(UNK)	1
82222910										Van/minivan	South	Turning left	Motor vehicle in pavement traffic	On-pavement (roadway)	(UNK)	(UNK)	(UNK)	(UNK)	(UNK)	2
6/17/2008 4:20 PM	Clear	Dry	0	0	0	0	15-Angle	Daylight	33.35	Passenger	North	Straight ahead	Motor vehicle in pavement traffic	On-pavement (roadway)	(UNK)	(UNK)	(UNK)	(UNK)	(UNK)	1
63405498										Passenger	East	Straight ahead	Motor vehicle in pavement traffic	On-pavement (roadway)	(UNK)	(UNK)	(UNK)	(UNK)	(UNK)	2
8/26/2008 12:29 PM	Clear	Dry	0	1	0	0	10-Turning	Daylight	33.35	Other	East	Turning left	Motor vehicle in n traffic	Intersection	(UNK)	(UNK)	(UNK)	(UNK)	(UNK)	1
										Passenger	North	Straight ahead	Motor vehicle in n traffic	Intersection	(UNK)	(UNK)	(UNK)	(UNK)	(UNK)	2



Collision Diagram

11/12/2008 to 12/31/2008

Crash Route: IL050 | From MileStation 33.35 to 33.35 | County: Cook | Intersection Related: Intersections | *See Notes at End of Report:

Date	Weather	Roadway	Injuries A	Injuries B	Injuries C	Killed	Type of Crash	Light Condition	Mile	Vehicle Type	DIRP	Maneuver	Event 1	Loc 1	Event 2	Loc 2	Event 3	Loc 3	Unit	
84428824										Passenger	West	Unknown/A	Motor vehicle in traffic	Intersection	(UNK)	(UNK)	(UNK)	(UNK)	(UNK)	3
11/12/2008 5:46 PM	Rain	Wet	0	0	0	0	11-Rear end	Darkness/Lighted road	33.35	Passenger	North	Other	Motor vehicle in pavement traffic (roadway)	On-pavement (roadway)	(UNK)	(UNK)	(UNK)	(UNK)	(UNK)	1
										Passenger	North	Straight ahead	Motor vehicle in pavement traffic (roadway)	On-pavement (roadway)	(UNK)	(UNK)	(UNK)	(UNK)	(UNK)	2
84551324										Passenger	West	Straight ahead	Motor vehicle in traffic	Intersection	(UNK)	(UNK)	(UNK)	(UNK)	(UNK)	1
11/20/2008 8:52 PM	Clear	Dry	0	0	1	0	15-Angle	Darkness/Lighted road	33.35	Van/minivan	North	Straight ahead	Motor vehicle in traffic	Intersection	(UNK)	(UNK)	(UNK)	(UNK)	(UNK)	2



Collision Diagram

1/1/2008 to 12/31/2008

Crash Route: IL050 | From MileStation 33.35 to 33.35 | County: Cook | Intersection Related: Intersections | *See Notes at End of Report.

TOTAL CRASHES	FATAL CRASHES	A INJURY CRASHES	B INJURY CRASHES	C INJURY CRASHES	PROPERTY DAMAGE CRASHES	TOTAL KILLED	TOTAL INJURED	A INJURIES	B INJURIES	C INJURIES
12	0	0	3	1	8	0	5	0	4	1

Type of Crash	Total	%	Day of Wk	Total	%	Hour of Day	Total	%	Vehicle Type	Total	%
10-Turning	6	50.0%	Monday	1	8.3%	08 AM	1	8.3%	Other	1	3.8%
11-Rear end	3	25.0%	Tuesday	2	16.7%	Noon	1	8.3%	Passenger	19	73.1%
12-Sidewipe same direction	1	8.3%	Wednesday	2	16.7%	2 PM	1	8.3%	Sport utility vehicle (SUV)	4	15.4%
15-Angle	2	16.7%	Thursday	2	16.7%	4 PM	1	8.3%	Van/mini van	2	7.7%
TOTAL:	12		Friday	4	33.3%	5 PM	3	25.0%	TOTAL:	26	
			Sunday	1	8.3%	6 PM	1	8.3%			
			TOTAL:	12		7 PM	1	8.3%			
						8 PM	2	16.7%			
						10 PM	1	8.3%			
						TOTAL:	12				

Weather Cond	Total	%	Light Cond	Total	%	Road Surface	Total	%	DIRP	Total	%
Clear	7	58.3%	Darkness	3	25.0%	Dry	7	58.3%	East	4	15.4%
Rain	2	16.7%	Darkness/Lighted road	4	33.3%	Snow or slush	3	25.0%	North	15	57.7%
Snow	3	25.0%	Daylight	5	41.7%	Wet	2	16.7%	South	4	15.4%
TOTAL:	12		TOTAL:	12		TOTAL:	12		West	3	11.5%
						TOTAL:	26		TOTAL:	26	

Collision Diagram

1/1/2008 to 12/31/2008

Crash Route: IL050 | From MileStation 33.35 to 33.35 | County: Cook | Intersection Related: Intersections | *See Notes at End of Report.

Notes

Current year and previous year data are not yet complete and are subject to change as more information becomes available. Calendar date selections include data based on the date of the crash. Year selections include data based on the statistical year in which the crash was processed.

The intersection-related field could be incorrect and affect the data on the report.

If a crash occurs between two municipalities, it may be coded to another city/county from what is on the crash report.

Crashes with incomplete location information are not included.

Areas where routes have more than one junction have been known to cause problems in determining accurate locations. Please notify us to verify the data for intersections with more than one junction.

For roadway segments which include the intersection of two routes, the intersection report may need to be run on the other route in order to get all the crashes.



Collision Diagram

1/1/2009 to 12/31/2009

Crash Route: IL050 | From MileStation 33.41 to 33.41 | County: Cook | Intersection Related: Intersections | *See Notes at End of Report.

Date	Weather	Roadway	Injuries A	Injuries B	Injuries C	Killed	Type of Crash	Light Condition	Mile	Vehicle Type	DIRP	Maneuver	Event 1	Loc 1	Event 2	Loc 2	Event 3	Loc 3	Unit	
200901184562	Clear	Dry	0	2	0	0	11-Rear end	Daylight	33.41	Passenger	East	Straight ahead	Motor vehicle in traffic	On-pavement (roadway)	(UNK)	(UNK)	(UNK)	(UNK)	(UNK)	1
200901200973										Passenger	East	Straight ahead	Motor vehicle in traffic	On-pavement (roadway)	(UNK)	(UNK)	(UNK)	(UNK)	(UNK)	2
7/7/2009 12:35 PM	Clear	Dry	0	0	0	0	11-Rear end	Daylight	33.41	Sport utility vehicle (SUV)	West	Straight ahead	Motor vehicle in traffic	Intersection	(UNK)	(UNK)	(UNK)	(UNK)	(UNK)	1
200901268680										Van/minivan	West	Slow/stop in traffic	Motor vehicle in traffic	Intersection	(UNK)	(UNK)	(UNK)	(UNK)	(UNK)	2
7/25/2009 4:38 PM	Clear	Dry	2	0	0	0	11-Rear end	Daylight	33.41	Passenger	East	Straight ahead	Motor vehicle in traffic	On-pavement (roadway)	(UNK)	(UNK)	(UNK)	(UNK)	(UNK)	1
200901326772										Passenger	East	Slow/stop in traffic	Motor vehicle in traffic	On-pavement (roadway)	(UNK)	(UNK)	(UNK)	(UNK)	(UNK)	2
8/27/2009 8:40 PM	Rain	Wet	0	0	2	0	10-Turning	Darkness/Lighted road	33.41	Sport utility vehicle (SUV)	South	Turning left	Motor vehicle in traffic	Intersection	(UNK)	(UNK)	(UNK)	(UNK)	(UNK)	1
200901336544										Sport utility vehicle (SUV)	North	Straight ahead	Motor vehicle in traffic	Intersection	(UNK)	(UNK)	(UNK)	(UNK)	(UNK)	2
9/22/2009 7:05 AM	Clear	Wet	0	0	0	0	11-Rear end	Daylight	33.41	Passenger	South	Other	Motor vehicle in traffic	Intersection	(UNK)	(UNK)	(UNK)	(UNK)	(UNK)	1
										Sport utility vehicle (SUV)	South	Sliding/crossroad loss	Motor vehicle in traffic	Intersection	(UNK)	(UNK)	(UNK)	(UNK)	(UNK)	2



Collision Diagram

1/1/2009 to 12/31/2009

Crash Route: IL050 | From Mile Station 33.41 to 33.41 | County: Cook | Intersection Related: Intersections | *See Notes at End of Report.

TOTAL CRASHES	FATAL CRASHES	A INJURY CRASHES	B INJURY CRASHES	C INJURY CRASHES	PROPERTY DAMAGE CRASHES	TOTAL KILLED	TOTAL INJURED	A INJURIES	B INJURIES	C INJURIES
10	0	2	3	2	3	0	16	3	3	5

Type of Crash	Total	%	Day of Wk	Total	%	Hour of Day	Total	%	Vehicle Type	Total	%
10-Turning	4	40.0%	Tuesday	4	40.0%	07 AM	1	10.0%	Passenger	14	66.7%
11-Rear end	6	60.0%	Wednesday	2	20.0%	08 AM	1	10.0%	Sport utility vehicle (SUV)	6	28.6%
TOTAL:	10		Thursday	2	20.0%	11 AM	1	10.0%	Van/mini van	1	4.8%
			Saturday	2	20.0%	Noon	1	10.0%	TOTAL:	21	
			TOTAL:	10		2 PM	1	10.0%			
						4 PM	2	20.0%			
						5 PM	1	10.0%			
						8 PM	1	10.0%			
						9 PM	1	10.0%			
						TOTAL:	10				

Weather Cond	Total	%	Light Cond	Total	%	Road Surface	Total	%	DIRP	Total	%
Clear	5	50.0%	Darkness/Lighted road	2	20.0%	Dry	4	40.0%	East	6	28.6%
Rain	3	30.0%	Daylight	7	70.0%	Snow or slush	2	20.0%	North	2	9.5%
Snow	2	20.0%	Dusk	1	10.0%	Wet	4	40.0%	South	10	47.6%
TOTAL:	10		TOTAL:	10		TOTAL:	10		West	3	14.3%
									TOTAL:	21	

Collision Diagram

1/1/2009 to 12/31/2009

Crash Route: IL050 | From MileStation 33.41 to 33.41 | County: Cook | Intersection Related: Intersections | *See Notes at End of Report.

Notes

Current year and previous year data are not yet complete and are subject to change as more information becomes available. Calendar date selections include data based on the date of the crash. Year selections include data based on the statistical year in which the crash was processed.

The intersection-related field could be incorrect and affect the data on the report.

If a crash occurs between two municipalities, it may be coded to another city/county from what is on the crash report.

Crashes with incomplete location information are not included.

Areas where routes have more than one junction have been known to cause problems in determining accurate locations. Please notify us to verify the data for intersections with more than one junction.

For roadway segments which include the intersection of two routes, the intersection report may need to be run on the other route in order to get all the crashes.



Illinois Department of Transportation
Division of Traffic Safety

Collision Diagram

1/1/2010 to 12/31/2010

Crash Route: IL050 | From MileStation 33.41 to 33.41 | County : Cook | Intersection Related: Intersections | *See Notes at End of Report.

Date	Weather	Roadway	Injuries	A	B	C	Killed	Type of Crash	Light Condition	Mile	Vehicle Type	DIRP	Maneuver	Ewnt1	Loc 1	Ewnt2	Loc 2	Ewnt3	Loc 3	Unit	
20 10 01033026	Clear	Dry	0	1	0	0	0	15-Angle	Daylight	33.41	Passenger	West	Straight ahead	Motor vehicle in lane	Overtake	(UNK)	(UNK)	(UNK)	(UNK)	(UNK)	1
20 10 01052205	Rain	Wet	0	0	1	0	0	11-Rear-end	Daylight	33.41	Passenger	South	Swi/stop in lane	Motor vehicle in lane	Overtake	(UNK)	(UNK)	(UNK)	(UNK)	(UNK)	1
20 10 01061574	Clear	Dry	0	0	0	0	0	15-Angle	Darkness/Lighted road	33.41	Passenger	West	Straight ahead	Motor vehicle in lane	Intersect	(UNK)	(UNK)	(UNK)	(UNK)	(UNK)	1
20 10 01073011	Clear	Dry	0	0	0	0	0	15-Angle	Daylight	33.41	Sport utility vehicle (SUV)	North	Straight ahead	Motor vehicle in lane	Intersect	(UNK)	(UNK)	(UNK)	(UNK)	(UNK)	2
20 10 01243221	Clear	Dry	0	1	1	0	0	11-Rear-end	Daylight	33.41	Passenger	West	Straight ahead	Motor vehicle in lane	Overtake	(UNK)	(UNK)	(UNK)	(UNK)	(UNK)	1
20 10 01344156	Rain	Wet	0	0	5	0	0	11-Rear-end	Daylight	33.41	Passenger	West	Swi/stop in lane	Motor vehicle in lane	Overtake	(UNK)	(UNK)	(UNK)	(UNK)	(UNK)	2
10 02 20 10 11 25 A M	Rain	Wet	0	0	5	0	0	11-Rear-end	Daylight	33.41	Van/minivan	South	Straight ahead	Motor vehicle in lane	Intersect	(UNK)	(UNK)	(UNK)	(UNK)	(UNK)	1
											Sport utility vehicle (SUV)	South	Swi/stop in lane	Motor vehicle in lane	Intersect	Ran off the roadway	Ran off the roadway	Ran off the roadway	Ran off the roadway	(UNK)	2



Collision Diagram
 1/1/2010 to 12/31/2010

Crash Route: IL050 | From MileStation 33.41 to 33.41 | County : Cook | Intersection Related: Intersections | *See Notes at End of Report.

Date	Weather	Roadway	Injuries	A	B	C	Killed	Type of Crash	Light Condition	Mile	Vehicle Type	DIRP	Maneuver	Ewnt1	Loc 1	Ewnt2	Loc 2	Ewnt3	Loc 3	Unit	
20 10/01/27/658																					
10/21/2010 7:10 PM	Clear	Dry	0	0	0	1	0	10-Turning	Darkness/Lighted road	33.41	Passenger	West	Turning left	Motor vehicle in lane	On- pavement (roadway)	(UNK)	(UNK)	(UNK)	(UNK)	(UNK)	1
											Sport utility vehicle (SUV)	West	Turning left	Motor vehicle in lane	On- pavement (roadway)	(UNK)	(UNK)	(UNK)	(UNK)	(UNK)	2

20 10/01/41/446																					
11/24/2010 10:35 PM	Rain	West	0	0	0	0	0	11-Rear end	Darkness/Lighted road	33.41	Passenger	North	Straight ahead	Motor vehicle in lane	On- pavement (roadway)	(UNK)	(UNK)	(UNK)	(UNK)	(UNK)	1
											Passenger	North	Straight ahead	Motor vehicle in lane	On- pavement (roadway)	(UNK)	(UNK)	(UNK)	(UNK)	(UNK)	2



Collision Diagram

1/1/2010 to 12/31/2010

Crash Route: IL050 | From MileStation 33.41 to 33.41 | County : Cook | Intersection Related: Intersections | *See Notes at End of Report.

TOTAL CRASHES	FATAL CRASHES	A INJURY CRASHES	B INJURY CRASHES	C INJURY CRASHES	PROPERTY DAMAGE CRASHES	TOTAL KILLED	TOTAL INJURED	A INJURIES	B INJURIES	C INJURIES
Z	0	0	2	3	2	0	10	0	2	8

Type of Crash	Total	%	Day of Wk	Total	%	Hour of Day	Total	%	Vehicle Type	Total	%
10-Traffic	1	14.3%	Wednesday	2	28.6%	11 AM	1	14.3%	Other	1	1.1%
11-Rear End	4	57.1%	Thursday	2	28.6%	Noon	1	14.3%	Passenger	8	57.1%
15-Air	2	28.6%	Saturday	2	28.6%	4 PM	1	14.3%	Pickup	1	1.1%
TOTAL:	7		Sunday	1	14.3%	7 PM	3	42.9%	Sport Utility Vehicle (SUV)	3	21.4%
			TOTAL:	7		10 PM	1	14.3%	Van/Minivan	1	1.1%
						TOTAL:	7		TOTAL:	14	

Weather Cond	Total	%	Light Cond	Total	%	Road Surface	Total	%
Clear	4	57.1%	Darkness/Dimmed road	3	42.9%	Dry	4	57.1%
Rain	3	42.9%	Daylight	4	57.1%	Wet	3	42.9%
TOTAL:	7		TOTAL:	7		TOTAL:	7	

Collision Diagram

1/1/2010 to 12/31/2010

Crash Route: IL050 | From MileStation 33.41 to 33.41 | County: Cook | Intersection Related: Intersections | *See Notes at End of Report.

Notes

Current year and previous year data are not yet complete and are subject to change as more information becomes available. Calendar date selections include data based on the date of the crash. Year selections include data based on the statistical year in which the crash was processed.

The intersection-related field could be incorrect and affect the data on the report.

If a crash occurs between two municipalities, it may be coded to another city/county from what is on the crash report.

Crashes with incomplete location information are not included.

Areas where routes have more than one junction have been known to cause problems in determining accurate locations. Please notify us to verify the data for intersections with more than one junction.

For roadway segments which include the intersection of two routes, the intersection report may need to be run on the other route in order to get all the crashes.

Traffic Volume

September 2008

This information was obtained via the Illinois Department of Transportation website per the RLR Guideline document published by the same. Only ADT values were available, peak numbers were not provided.

IL Route 50 ADT

- North of 183rd St is 18,800
- South of 183rd St is 16,600

183rd St ADT

- East of Route 50 is 16,500
- West of Route 50 is 9,100

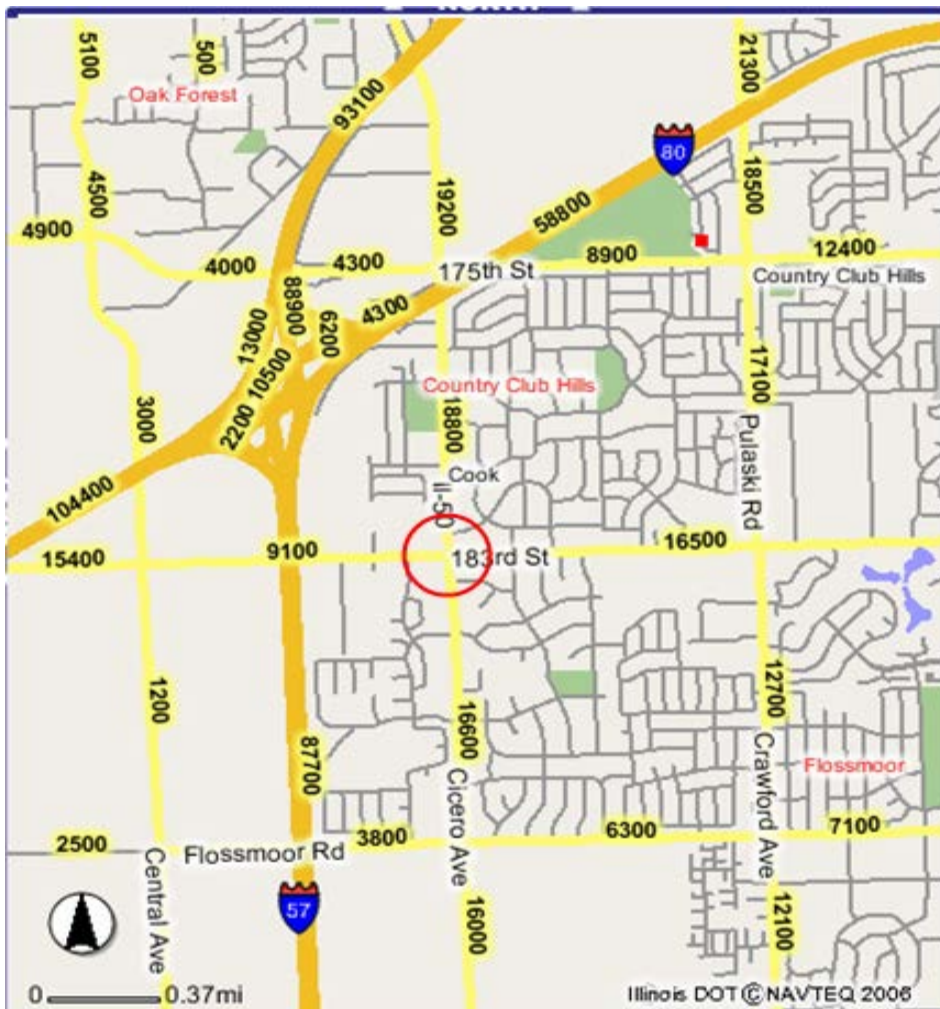

January 2010

This information was obtained via the Illinois Department of Transportation website per the RLR Guideline document published by the same. Only ADT values were available, peak numbers were not provided.

IL Route 50 ADT

- North of 183rd St is 16,800
- South of 183rd St is 14,600

183rd St ADT

- East of Route 50 is 16,500
- West of Route 50 is 9,100

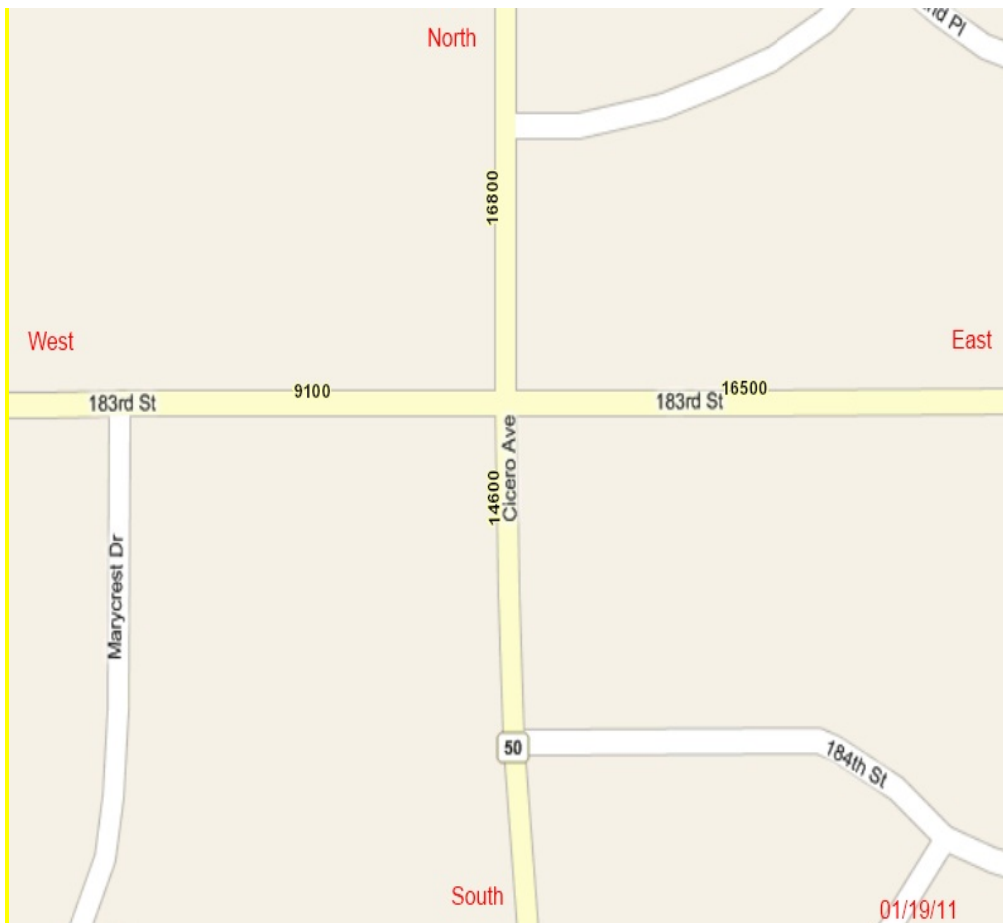

Summary

In 2007 almost 900 people were killed and an estimated 153,000 were injured in crashes that involved red light running in the US. About half of the deaths in red light running crashes are pedestrians and occupants in other vehicles who are hit by red light runners. Studies have reported that red light cameras reduce angle and turning crashes. Because the types of crashes prevented by red light cameras tend to be more severe than rear-end crashes, research has shown there is also a reduction in the severity of crashes.

All processes are in compliance with the RLR regulations laid out by the Illinois Department of Transportation District 1 Bureau of Traffic Operations.

The RLR camera system went live on 8/6/2009 for Northbound IL Route 50 at 183rd Street. On 8/7/2009, the RLR camera system went live for Southbound IL Route 50 at 183rd Street. There have been no Signal timing changes or any other Traffic Controller setting changes.

Numerous studies from the US, as well as the experience of many other cities, indicate decreases in red light running violations and collisions after cameras were installed and Northbound and Southbound IL Route 50 at 183rd Street was not an exception. Crash data from 2008 to 2010 shows "Turning" accidents were reduced by 83.33% at this red-light camera intersection, with a 41.67% reduction in "Total" accidents. Other intersections not monitored by automated enforcement may also experience a decrease in violations and accidents as a result of the presence of this automated enforcement system changing driving behaviors.